

# PALMERTON AREA SCHOOL DISTRICT

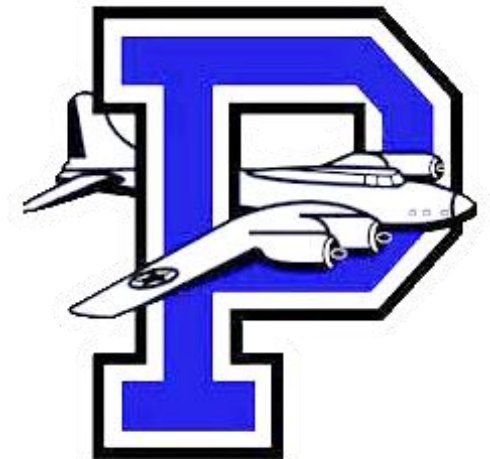

## Design Team

### RLPS Architects

Chris Linkey, AIA, NCARB  
Mike Savage, AIA, NCARB  
Erin Hoffman, ALEP  
Andy Blaydon, AIA



Partner-in-Charge  
Feasibility Study Lead  
Educational Specialist  
Enrollment Study Lead

### Civil Engineer

Barry Isett & Associates, Inc.



### MEP Engineer

Barton Associates, Inc.

Robert A. Sells, PE, CSI



Senior Project Manager

## Palmerton Area School District

### Steering Committee

Ryan Kish

Jamie Schuler

Joe Faenza

Kris Schaible

Earl Paules



Interim Superintendent/  
Business Administrator

Assistant to the Superintendent

Director of Facilities

School Board Director

School Board Director





# **WHY? Conduct a Feasibility Study**

**Evaluate Existing Facilities**

**Evaluate Current and Future Enrollment**

**Evaluate Current and Future Curriculum Needs**

**Needs of Buildings are Increasing**

- Additional Special Education Spaces
- Flexible Spaces and Future Ready

**Need for an Updated District Master Plan**

# FEASIBILITY STUDY SCHEDULE

## PALMERTON AREA SCHOOL DISTRICT

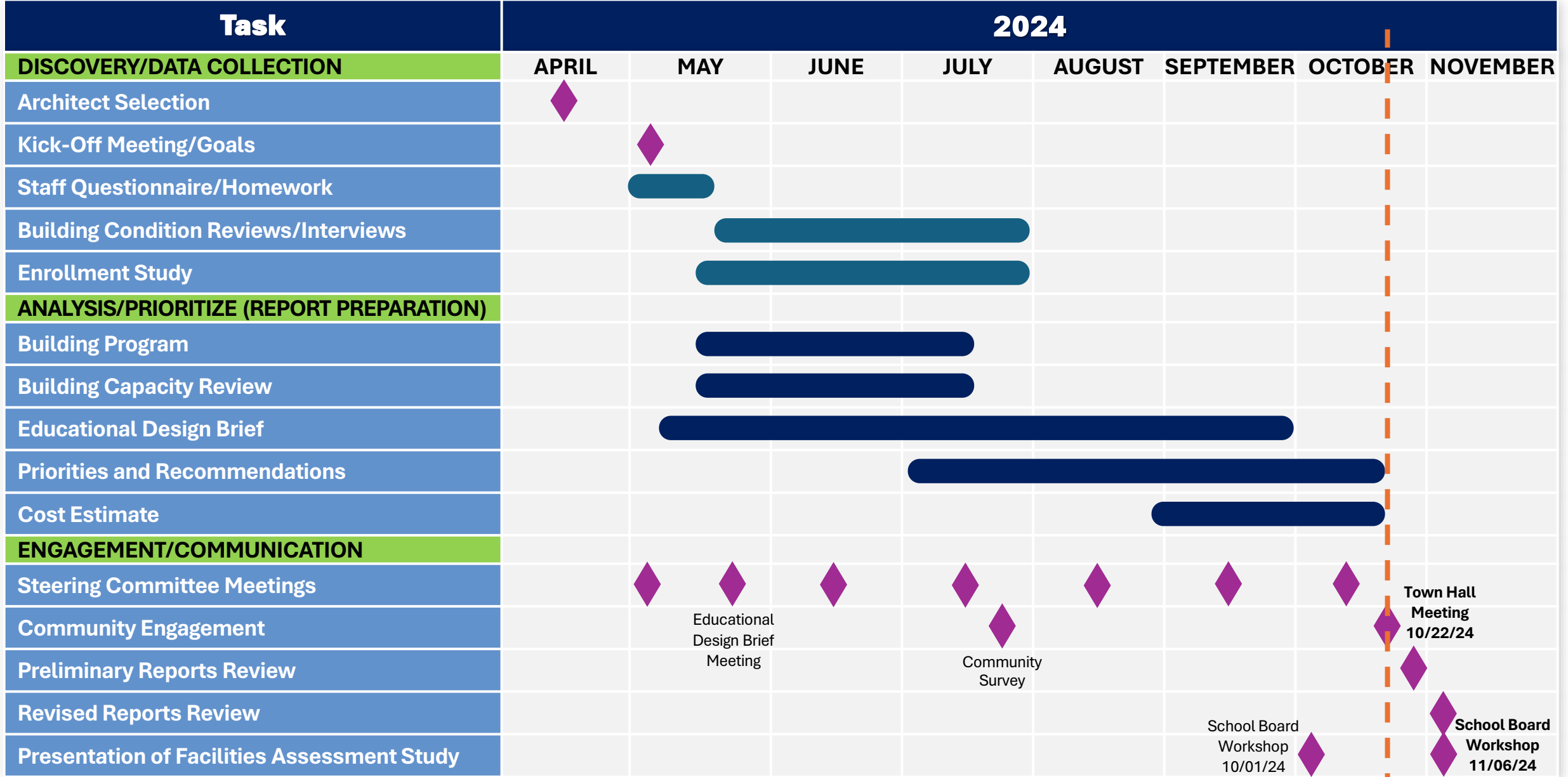

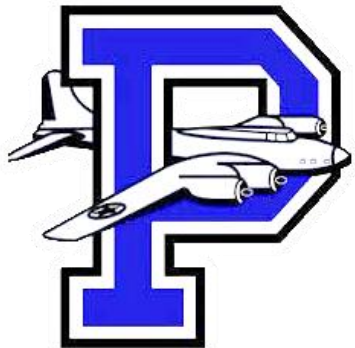

- 1 JR/SR HIGH SCHOOL  
7-12
- 2 S.S. PALMER ES  
2-6
- 3 PARKSIDE EDUCATION CTR  
K-1
- 4 TOWAMENSING ES  
K-6



**Palmerton Area School District**

**Palmerton Borough  
Bowmanstown Borough  
Towamensing Township  
Lower Towamensing Township**

# Enrollment Projections

- **Methodologies**

- **PA Department of Education**

- Based on actual live births

- **Grade Progression Ratio**

- Based on historical enrollment data for Palmerton Area School District

- **Housing Start Data**

- Palmerton Borough
- Bowmanstown Borough
- Towamensing Twp.
- Lower Towamensing Twp.

*no new neighborhoods planned*  
*no new neighborhoods planned*  
*no new neighborhoods planned*  
*no new neighborhoods planned*



# Enrollment Projections

- **Summary**

- May 2024 Enrollment: 1,609 students
- PA Department of Education and Grade Progression Ratio Projections
- **Enrollment will remain relatively flat over the next 10 years**

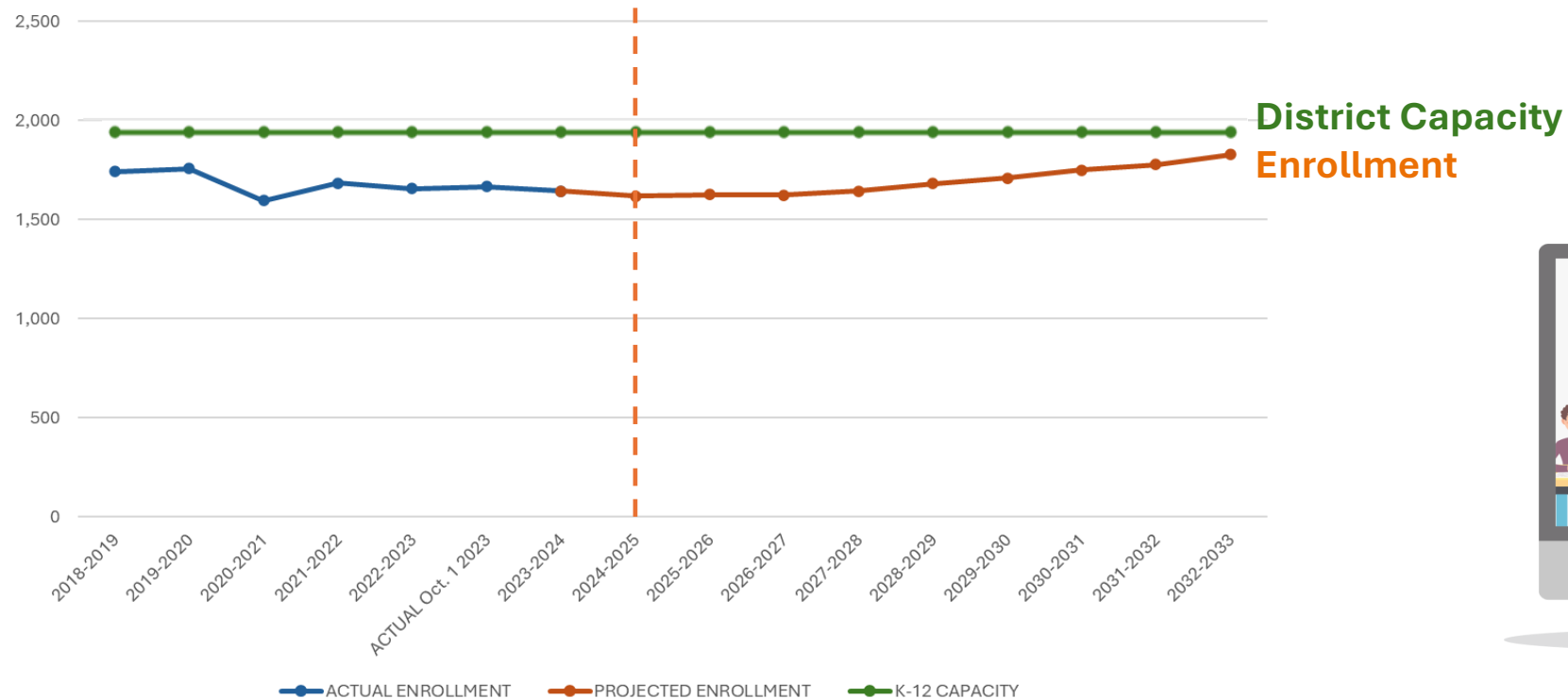

# Current Enrollment and Capacities

	<u>Parkside</u>	<u>S.S. Palmer</u>	<u>Towamensing</u>	<u>Junior HS</u>	<u>Senior HS</u>
Current Enrollment 1,609	143	393	338	268	467
Building Capacity 1,908	162	442	382	344	578

- District facilities currently have capacity for the current enrollment
- Facility needs are increasing – Growing Special Education Requirements
  - District facilities lack spaces to accommodate these growing needs, forcing education to take place in corridors, stairs and closets



# Educational Design Brief

*Educating the whole child* is a goal for the Palmerton Area School District.

## Future Curriculum Goals:

- **Develop a robust, vertically aligned standards-based curriculum**
- **Develop a K-8 Multi-Tiered System of Support**
  - Supports students' social, emotional and behavioral needs
- **Establish a data-driven instruction and assessment culture**
  - Use PASD's edInsight data and curriculum management software
- **Establish a student-centered learning environment**
  - Give students more choice in the curriculum



**EDUCATIONAL  
GOALS**



**CURRICULUM  
SHIFTS**



**LEARNING  
METHODS**



**ORGANIZATIONAL  
SHIFTS**



# Community Survey:

Timeframe: 7/22/2024 – 8/4/2024

Responses: 277 responses

## Advertisement:

- 5,000 phone calls to households
- 4,000 emails to community members
- Facebook
- School district website

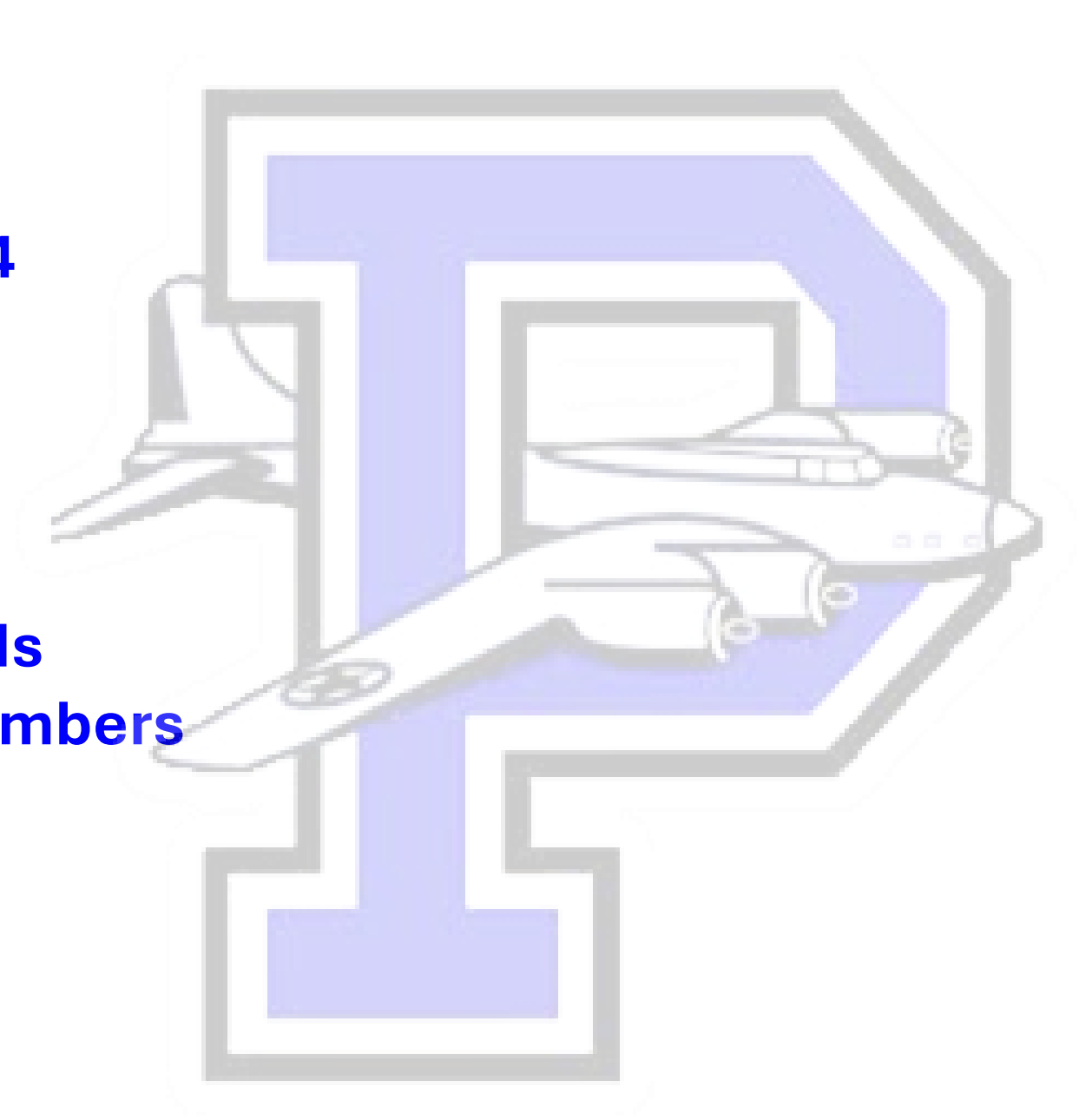

# Community Survey:

## Summary:

- **PASD distinguisher:** *Community Involvement*
- **Biggest challenges:** *Curriculum, Funding and Building Condition*
- **Priorities:** *Equity at Elementary Level, Safety & Security*
- **The community understands which schools are in the best condition.**
- **The programs that the community values the most are:**
  - *Music*
  - *Sports*
  - *Drama/Performing Arts*



# Community Survey:

## Summary (continued):

- **Programs that the Community would like to see:**
  - *Financial Literacy*
  - *Family Consumer Sciences*
- **The Community would like the Feasibility Study to solve:**
  - *Academics*
  - *Facility upgrades/improvements*
  - *Equity across Elementary Buildings*

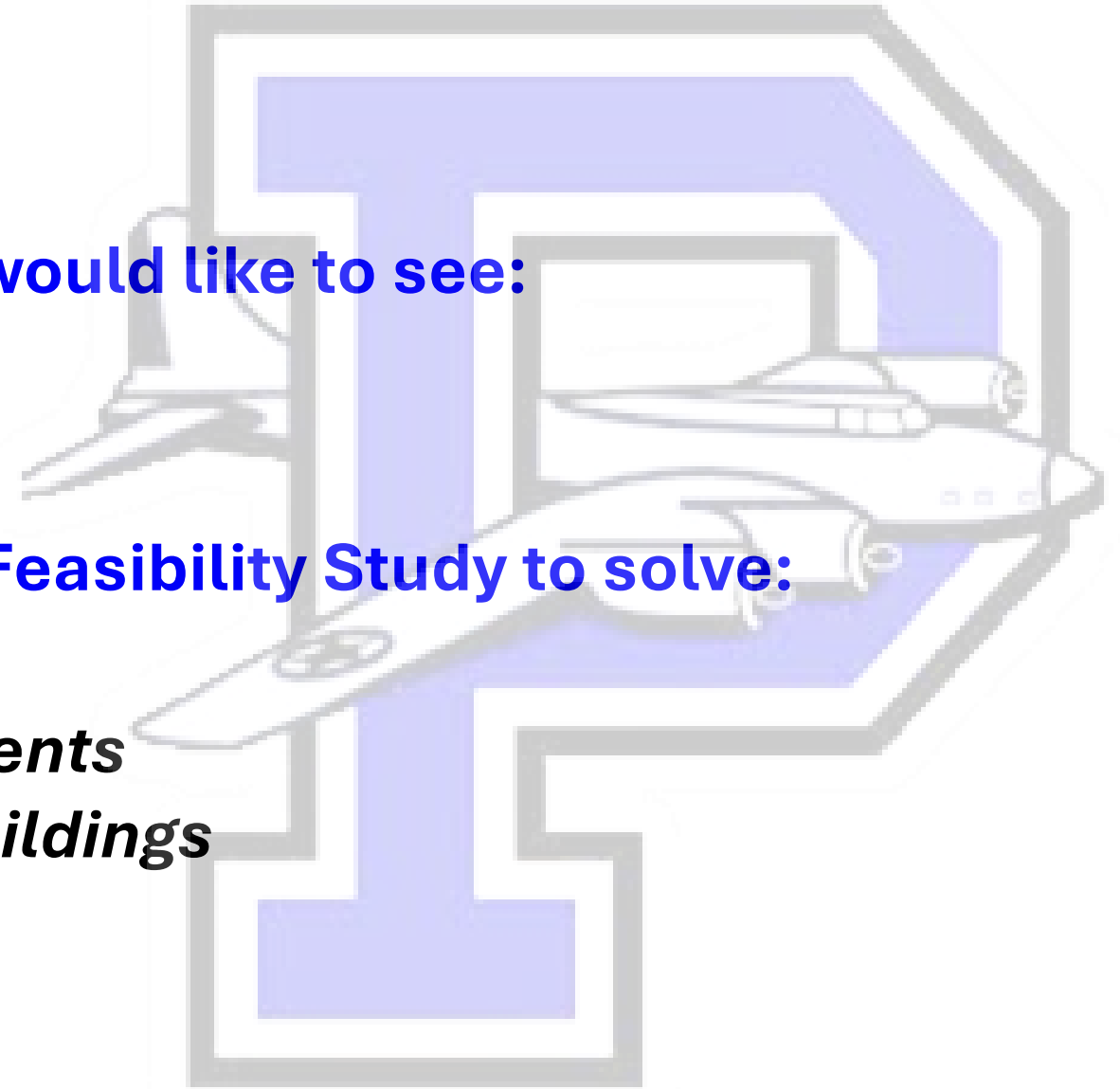

# Existing Facility Evaluations:

## Facilities evaluated in the following categories:

- Building & Property (Intangibles)
- Site Conditions
- General Education & Program
- Building Condition
- Systems Condition

## 0-4 Rating System

Rating Scale:
0.0 = Consider Demolition
1.0 = Weigh Heavy Renovations vs Discontinued Use or Demolition
2.0 = Heavy Renovations or Alterations needed
3.0 = Light Renovations or Capital Projects needed
4.0 = Brand New or Like-New Facility

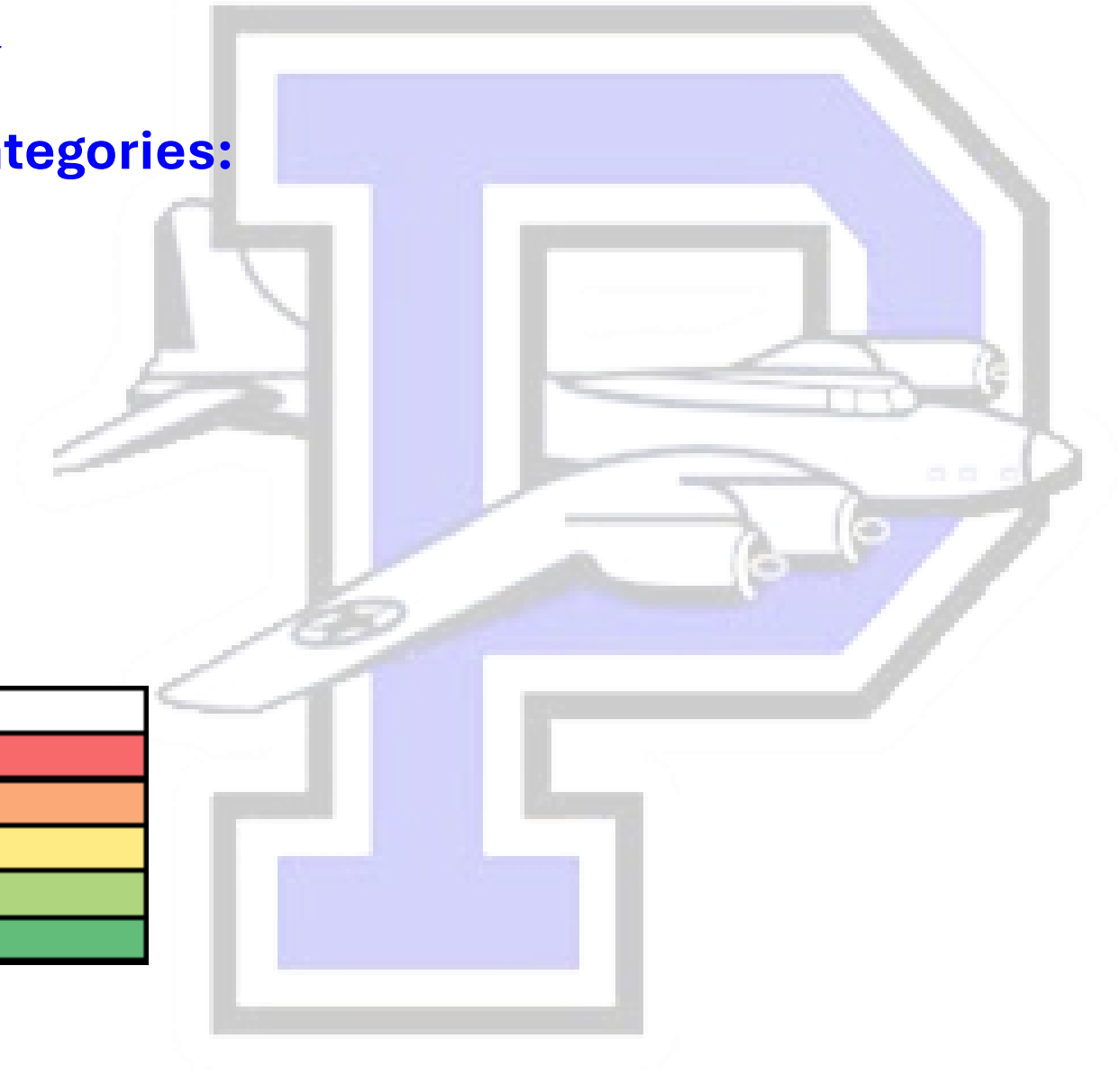

# Existing Facility Evaluation Summary:

PALMERTON AREA SCHOOL DISTRICT - EXISTING BUILDING SUMMARY											
Building Identity		Building Data		Capacity & Enrollment		Building Condition Evaluation					
BUILDING NAME	Year Built/ Renovations	SITE (acres)	Total Building (SF)	DISTRICT CAPACITY	2023/2024 ENROLLMENT	OVERALL CONDITION	BUILDING & PROPERTY (INTANGIBLES)	SITE CONDITIONS	GENERAL EDUCATION & BUILDING (PROGRAM)	BUILDING CONDITION	SYSTEMS CONDITION
<b>ELEMENTARY BUILDINGS</b>				100%							
Parkside Education Center	1938, 2008	0.7	31,260	162	143	2.44	2.44	2.11	2.00	2.24	2.20
S.S. Palmer Elementary School	1924, 1985, 2024	1.04	64,670	442	393	2.20	2.26	2.29	2.22	1.96	2.43
Towamensing Elementary School	1954, 2008	14	72,235	382	338	2.40	2.42	2.25	2.44	2.21	2.68
Palmerton Junior High School	1985, 2018	52.5	59,805	344	268	2.70	2.73	2.33	2.90	2.90	2.84
Palmerton Senior High School	1965, 2012, 2016, 2019, 2022	52.5*	119,943	578	467	2.50	2.59	2.33	2.45	2.55	2.34
Maintenance Building		52.5*				2.73	2.67	3.00	3.00	3.00	2.00
Field House		52.5*	6,995			2.98	2.95	3.00	3.00	2.94	3.00
Wrestling / Team Room Building		52.5*				3.10	2.50	3.00	3.00	3.00	4.00
Stadium		52.5*				2.76	3.00	3.00	3.00	3.00	1.80
		*shared - Jr. & Sr. HS									
<b>GRAND TOTALS</b>	<b>DISTRICT TOTALS</b>	<b>68.24</b>	<b>354,908</b>								
		ACRES	SF								
<p>The following factors provide an overall approach to assessing the usefulness, value and condition of a particular facility. The first column indicates the rating for the overall building, taking all of the categories into account. The following columns indicate the rating for five categories of the building assessment that directly contribute to the overall building rating.</p>						<p><b>Rating Scale:</b></p> <p>0.0 = Consider Demolition</p> <p>1.0 = Weigh Heavy Renovations vs Discontinued Use or Demolition</p> <p>2.0 = Heavy Renovations or Alterations needed</p> <p>3.0 = Light Renovations or Capital Projects needed</p> <p>4.0 = Brand New or Like-New Facility</p>					

# Existing Facility Evaluation Summary:

BUILDING NAME	OVERALL CONDITION	BUILDING & PROPERTY (INTANGIBLES)	SITE CONDITIONS	GENERAL EDUCATION & BUILDING (PROGRAM)	BUILDING CONDITION	SYSTEMS CONDITION
<b>ELEMENTARY BUILDINGS</b>						
Parkside Education Center	2.44	2.44	2.11	2.00	2.24	2.20
S.S. Palmer Elementary School	2.20	2.26	2.29	2.22	1.96	2.43
Towamensing Elementary School	2.40	2.42	2.25	2.44	2.21	2.68
Palmerton Junior High School	2.70	2.73	2.33	2.90	2.90	2.84
Palmerton Senior High School	2.50	2.59	2.33	2.45	2.55	2.34
Maintenance Building	2.73	2.67	3.00	3.00	3.00	2.00
Field House	2.98	2.95	3.00	3.00	2.94	3.00
Wrestling / Team Room Building	3.10	2.50	3.00	3.00	3.00	4.00
Stadium	2.76	3.00	3.00	3.00	3.00	1.80

- ALL DISTRICT FACILITIES NEED CAPITAL IMPROVEMENTS TO REPAIR OR REPLACE MEP SYSTEMS, SITE FEATURES AND WORN/FAILING FINISHES.
- SPACE MUST BE REALLOCATED OR ADDED FOR SPECIAL EDUCATION AND SMALL GROUP INSTRUCTION.

Rating Scale:
0.0 = Consider Demolition
1.0 = Weigh Heavy Renovations vs Discontinued Use or Demolition
2.0 = Heavy Renovations or Alterations needed
3.0 = Light Renovations or Capital Projects needed
4.0 = Brand New or Like-New Facility

## OPTION A: Status Quo

*Repair immediate needs and address security concerns at all schools*

Parkside:  
K&1 / District Admin.

SS Palmer:  
2-6

Towamensing:  
K-6

Jr. HS:  
7&8

HS:  
9-12

## OPTION B: Grade Realignment

Parkside:  
**K / District Admin.**

Towamensing:  
**1-3**

SS Palmer:  
**4-6**

Jr. HS:  
7&8

HS:  
9-12

## OPTION C: K Addition At Towamensing

Parkside:  
**District Admin.**

Towamensing:  
**K-3**

SS Palmer:  
**4-6**

Jr. HS:  
7&8

HS:  
9-12

## OPTION D: 6<sup>th</sup> Grade & District Admin. at Jr. High

Parkside:  
**K**

Towamensing:  
**1-3**

SS Palmer:  
**4-6**

- **SS Palmer under-utilized**
- **6<sup>th</sup> grade and District Admin at Junior HS requires 2 additions – more expensive**

## OPTION E: 6<sup>th</sup> Grade at Jr. High / HS Admin. Addition

Parkside:  
**District Admin.**

Towamensing:  
**K-2**

SS Palmer:  
**3-5**

Jr. HS:  
**6-8**

HS:  
9-12 **with HS Admin. Addition**





# Options Matrix

Option A:  
Status Quo

Option B:  
Grade Realign

Option C:  
K Addition

Option E:  
6<sup>th</sup> Addition

PROGRAM	Option A: Status Quo	Option B: Grade Realign	Option C: K Addition	Option E: 6 <sup>th</sup> Addition
Address Capacity & Enrollment		✓	✓	✓
Equality at Elementary Level		✓	✓	✓
Efficient Grade Configurations		✓	✓	✓
Address Safety & Security Concerns	✓	✓	✓	✓
Provide appropriate Educ. Spaces			✓	✓
Entire Admin. Team in same office			✓	✓
Additional Small Group and Meeting Rms		✓	✓	✓
OPERATIONS				
Efficiency of Services		✓	✓	✓
Minimize Budget Expenditures	✓	✓		

**OPTION A:**  
Status Quo

*Repair immediate needs and address security concerns at all schools*

Parkside:  
*K&1 / District Admin.*

SS Palmer:  
*2-6*

Towamensing:  
*K-6*

Jr. HS:  
*7&8*

HS:  
*9-12*

**OPTION B:**  
Grade  
Realignment

Parkside:  
**K / District Admin.**

Towamensing:  
**1-3**

SS Palmer:  
**4-6**

Jr. HS:  
*7&8*

HS:  
*9-12*

**OPTION C:**  
K Addition  
At  
Towamensing

Parkside  
**District Admin. (Renovation)**

Towamensing:  
**K-3 (K Addition)**

SS Palmer:  
*4-6*

Jr. HS:  
*7&8*

HS:  
*9-12*

**OPTION D:**  
6<sup>th</sup> Grade &  
District Admin.  
at Jr. High

Parkside:  
**K**

Towamensing:  
**1-3**

SS Palmer:  
**4&5**

Jr. HS:  
**6-8 & District Admin.**

HS:  
*9-12*

**OPTION E:**  
~~6<sup>th</sup> Grade at~~  
~~Jr. High / HS~~  
Admin.  
Addition

Parkside:  
**District Admin.**

Towamensing:  
**K-2**

SS Palmer:  
**3-5**

Jr. HS:  
**6-8**

HS:  
**9-12 with HS Admin. Addition**

Combined  
Option B,  
Option C  
and  
Partial  
Option E

## 1-YEAR PLAN:

Grade Realignment  
& Secure Entry at  
High School

Parkside:  
**K / District Admin.**

Towamensing:  
**1-3**

SS Palmer:  
**4-6**

Jr. HS:  
7&8

HS:  
9-12  
**(with Secure Entry)**

## 3-YEAR PLAN:

Kindergarten  
Addition at  
Towamensing

Parkside:  
**District Admin.  
(Renovation)**

Towamensing:  
**K-3 (K Addition)**

SS Palmer:  
4-6

Jr. HS:  
7&8

HS:  
9-12  
**(with Secure Entry)**

## 5-YEAR PLAN:

High School  
Administration  
Addition

Parkside:  
District Admin.

Towamensing:  
K-3

SS Palmer:  
4-6

Jr. HS:  
7&8

HS:  
9-12 **(with HS  
Admin. Addition)**

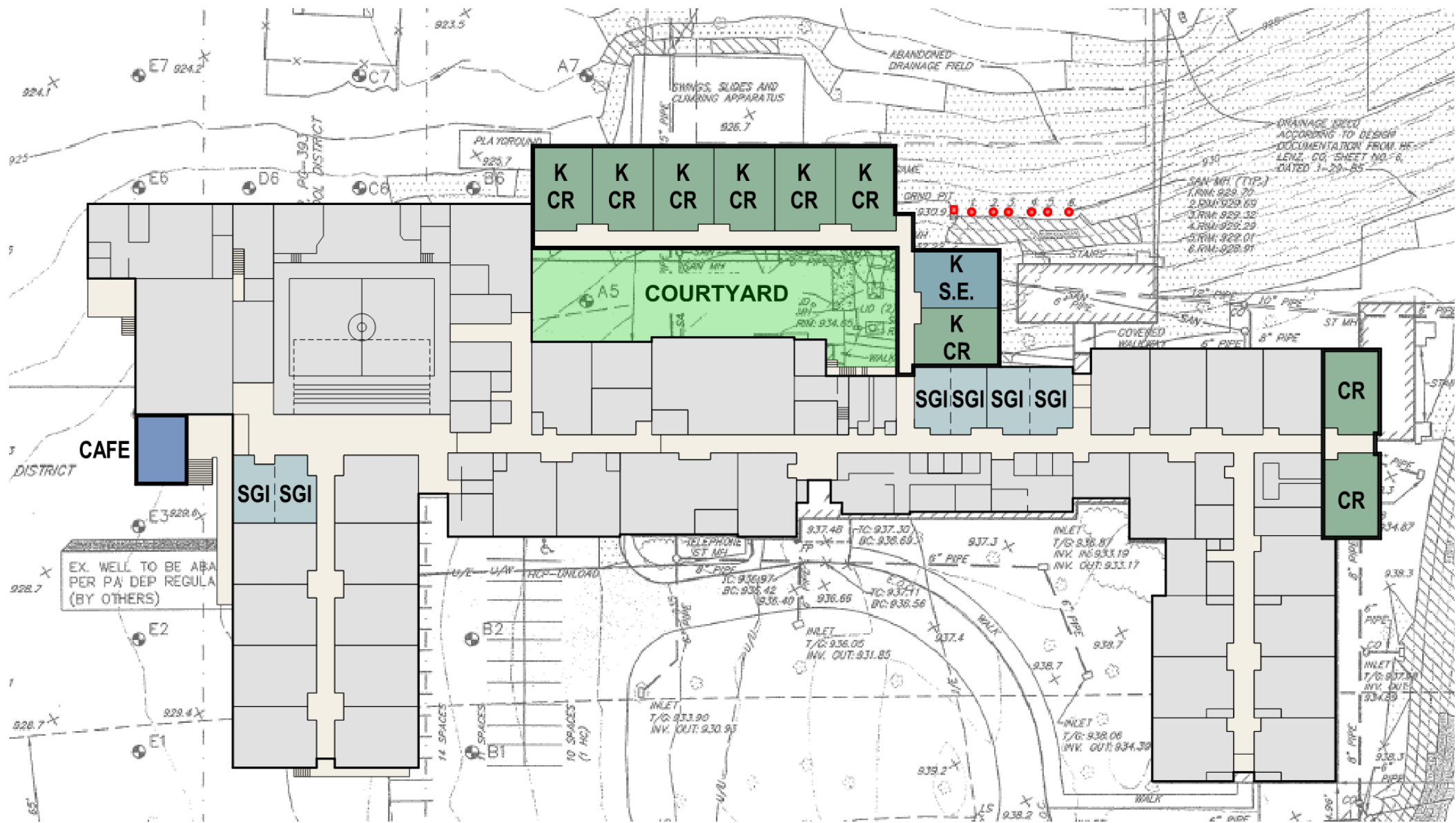

**Towamensing – First Floor**



# Cost Comparison: 1-Year Plan

## 1-Year Plan Grade Realignment / Secure HS Entry

**Construction Costs + Soft Costs**

**\$493,000 - \$518,000**

**Capital Improvements: (immediate repairs or replacement)**

- **Parkside Education Center** **\$0**
- **S.S. Palmer Elementary** **\$89,000 - \$112,000**
- **Towamensing Elementary** **\$229,000 - \$289,000**
- **Junior High School** **\$107,000 - \$139,000**
- **Senior High School** **\$362,000 - \$463,000**
- **Stadium / Fieldhouse / Maintenance Building** **\$58,000 - \$75,000**

**TOTAL PROJECT COST:**

**\$1,338,000 - \$1,596,000**



# Cost Comparison: 3-Year Plan

## 3-Year Plan Kindergarten Addition at Towamensing

**Construction Costs + Soft Costs**

**\$7,627,000 - \$8,619,000**

### **Capital Improvements: (HVAC Systems)**

- Parkside Education Center** **\$0**
- S.S. Palmer Elementary** **\$0**
- Towamensing Elementary** **\$1,150,000 - \$1,400,000**
- Junior High School** **\$0**
- Senior High School** **\$0**
- Stadium / Fieldhouse / Maintenance Building** **\$0**

**TOTAL PROJECT COST:**

**\$8,777,000 - \$10,019,000**



# Cost Comparison: 5-Year Plan

## 5-Year Plan High School Administration Addition

**Construction Costs + Soft Costs**

**\$2,754,000 - \$3,035,000**

### Capital Improvements:

- **Parkside Education Center** **\$0**
- **S.S. Palmer Elementary** **\$0**
- **Towamensing Elementary** **\$0**
- **Junior High School** **\$0**
- **Senior High School** **\$0**
- **Stadium / Fieldhouse / Maintenance Building** **\$0**

**TOTAL PROJECT COST:**

**\$2,754,000 - \$3,035,000**

# 1-YEAR PLAN:

Grade Realignment & Secure Entry at High School

Parkside:  
**K / District Admin.**

Towamensing:  
**1-3**

SS Palmer:  
**4-6**

Jr. HS:  
7&8

HS:  
9-12  
**(with Secure Entry)**

**Total Project Cost:**  
**\$1,338,000 –**  
**\$1,596,000**

# 3-YEAR PLAN:

Kindergarten Addition at Towamensing

Parkside:  
**Dist. Admin. (Renovation)**

Towamensing:  
**K-3 (K Addition)**

SS Palmer:  
4-6

Jr. HS:  
7&8

HS:  
9-12  
**(with Secure Entry)**

**Total Project Cost:**  
**\$8,777,000 –**  
**\$10,019,000**

# 5-YEAR PLAN:

High School Administration Addition

Parkside:  
District Admin.

Towamensing:  
K-3

SS Palmer:  
4-6

Jr. HS:  
7&8

HS:  
9-12 **(with HS Admin. Addition)**

**Total Project Cost:**  
**\$2,754,000 –**  
**\$3,035,000**



**Total Project Cost for 1, 3 and 5 year plan:**

**\$12,869,000 –**  
**\$14,650,000**



## Next Steps:

- **Consider feedback from Town Hall Meeting and revise Options as required.**
- **Continue to work with Bus Company to finalize proposed bus routes and cost for Grade Realignment.**
- **Preliminary Feasibility Study Report issued to Steering Committee: 10/25/24**
- **Presentation of Final Feasibility Study to School Board: 11/06/24**
- **Final Feasibility Study Report issued to School Board: 11/15/24**

# THANK YOU!

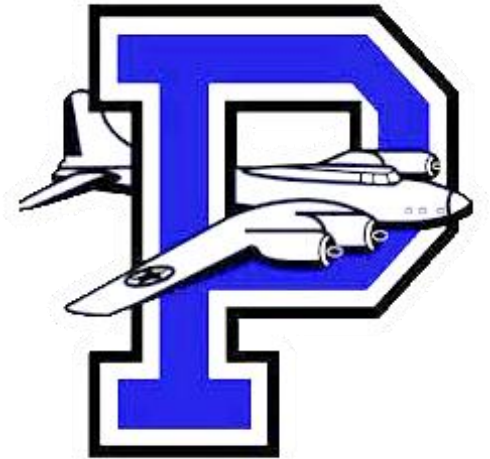



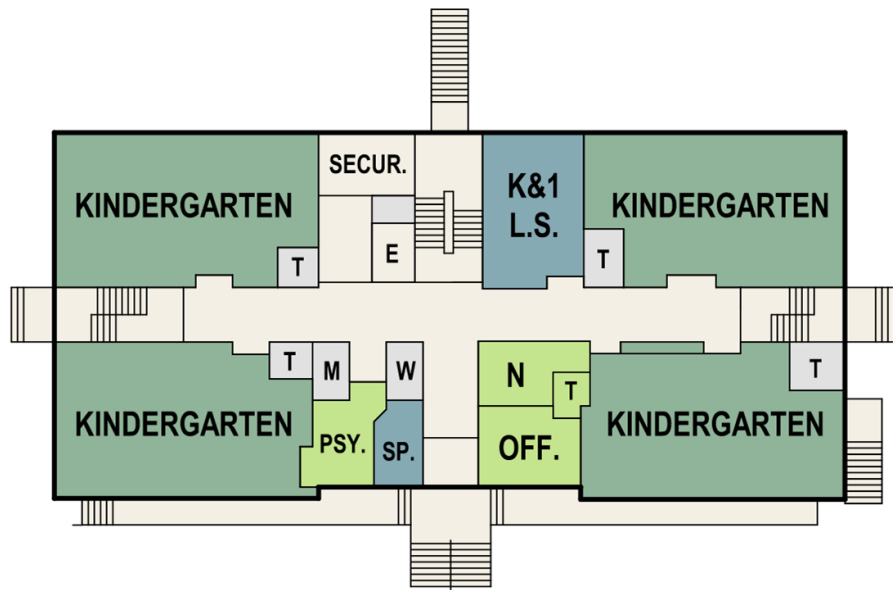

**Parkside – First Floor** Realignment of Classrooms

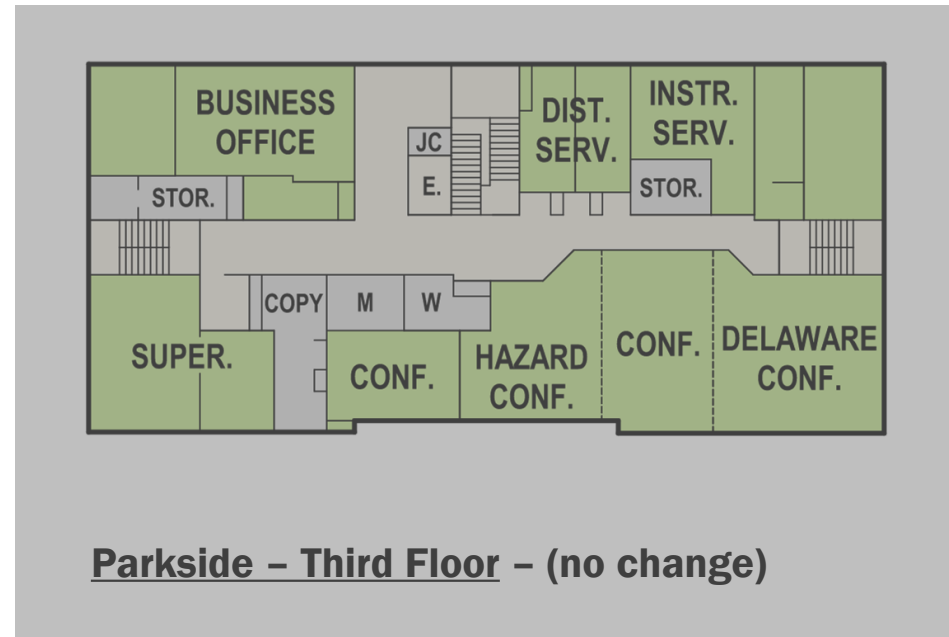

**Parkside – Third Floor – (no change)**

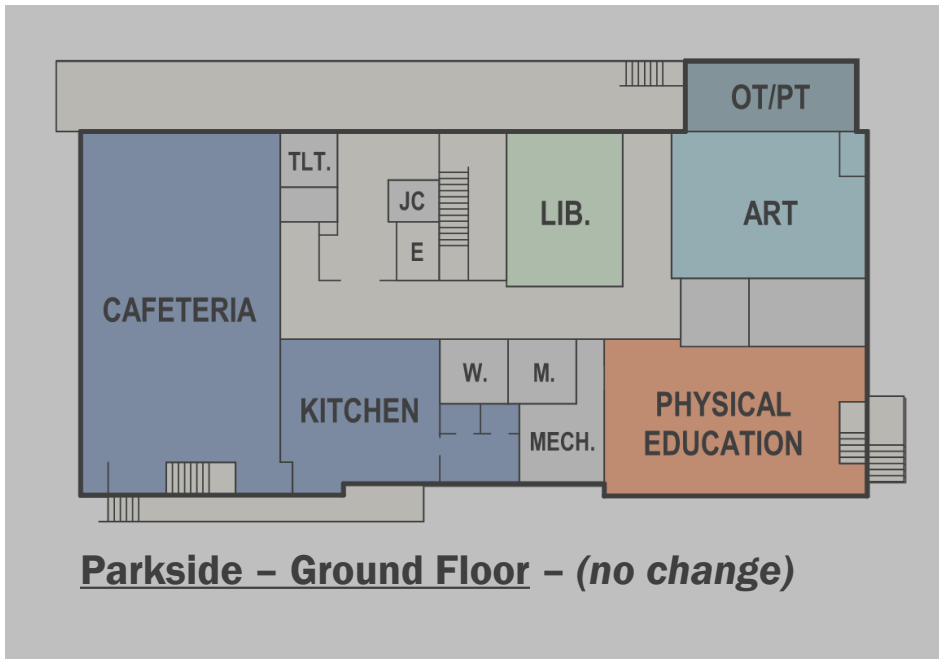

**Parkside – Ground Floor – (no change)**

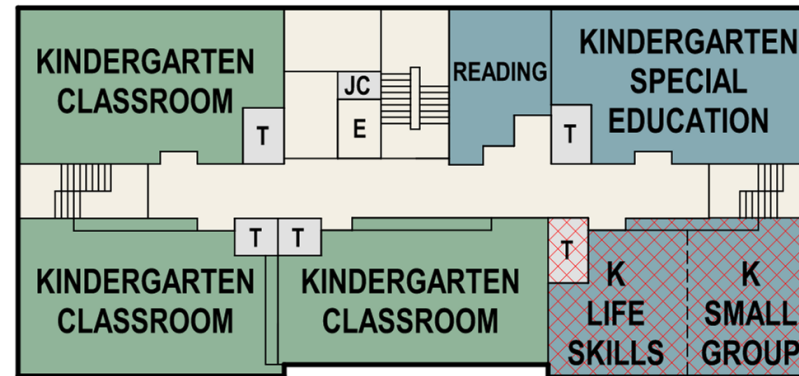

**Parkside – Second Floor**

Realignment of Classrooms/Renovation

RENOVATE CLASSROOM INTO LIFE SKILLS AND SMALL GROUP

## LOWER LEVEL

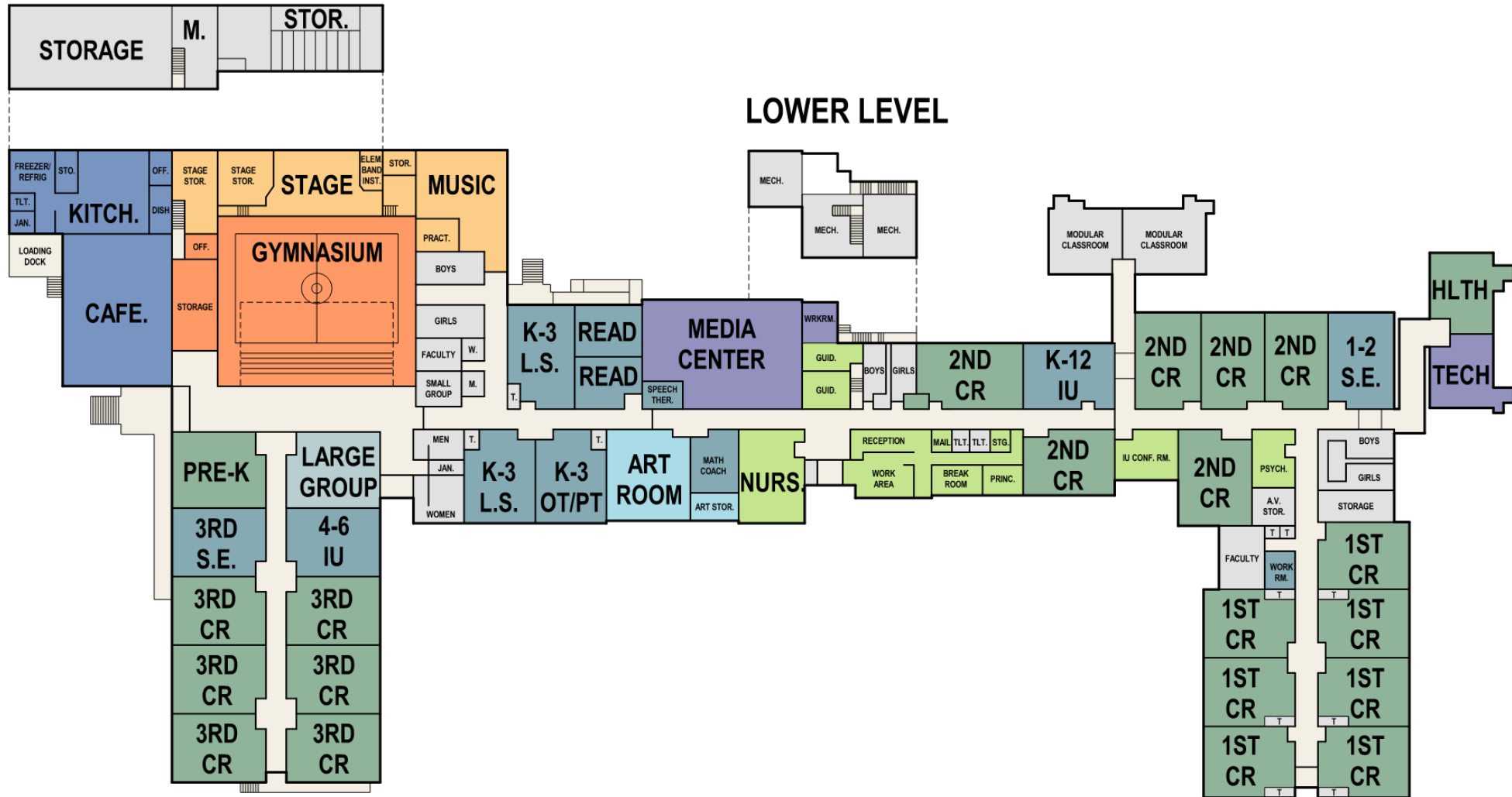

**Towamensing – First Floor Realignment of Classrooms**

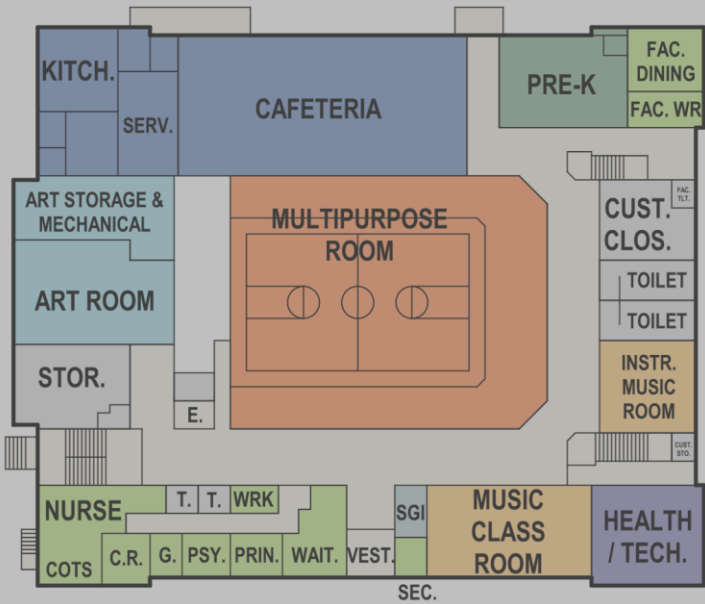

**S.S. Palmer – First Floor - (no change)**

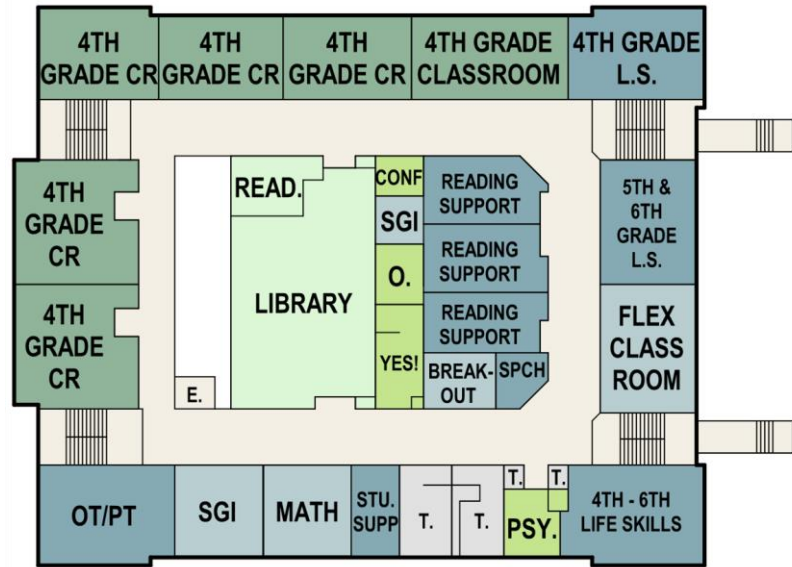

**S.S. Palmer – Second Floor  
Realignment of Classrooms**

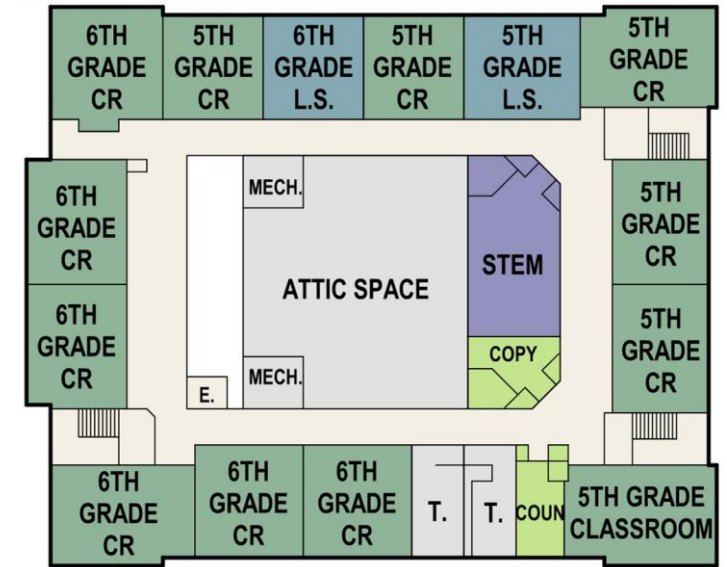

**S.S. Palmer – Third Floor  
Realignment of Classrooms**



**Senior High School – First Floor**

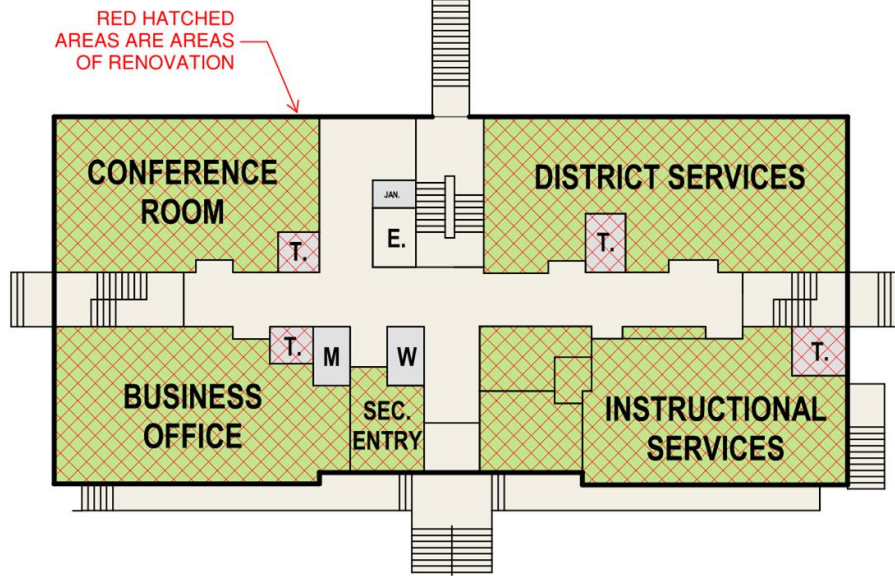

**Parkside - First Floor**

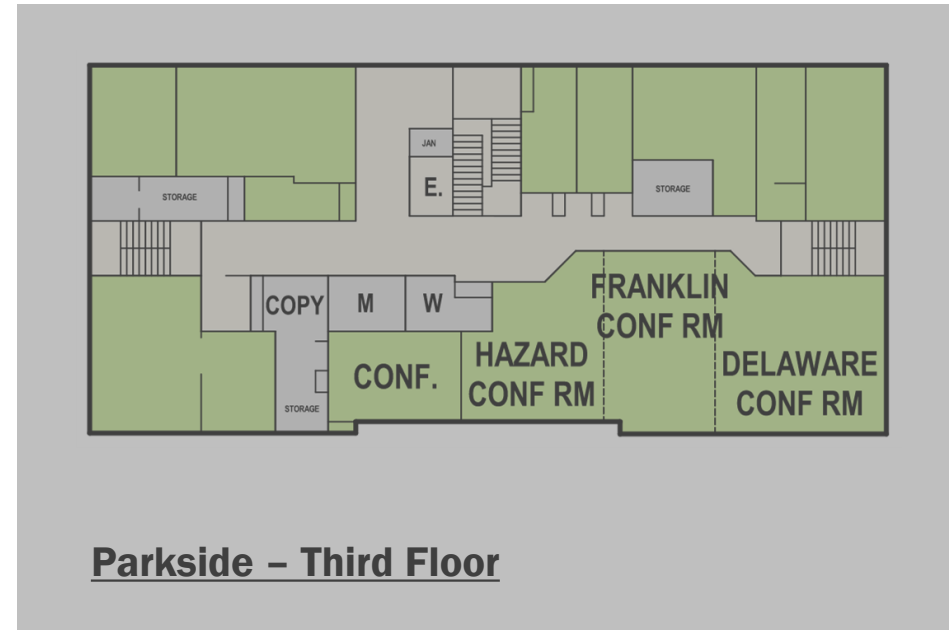

**Parkside - Third Floor**

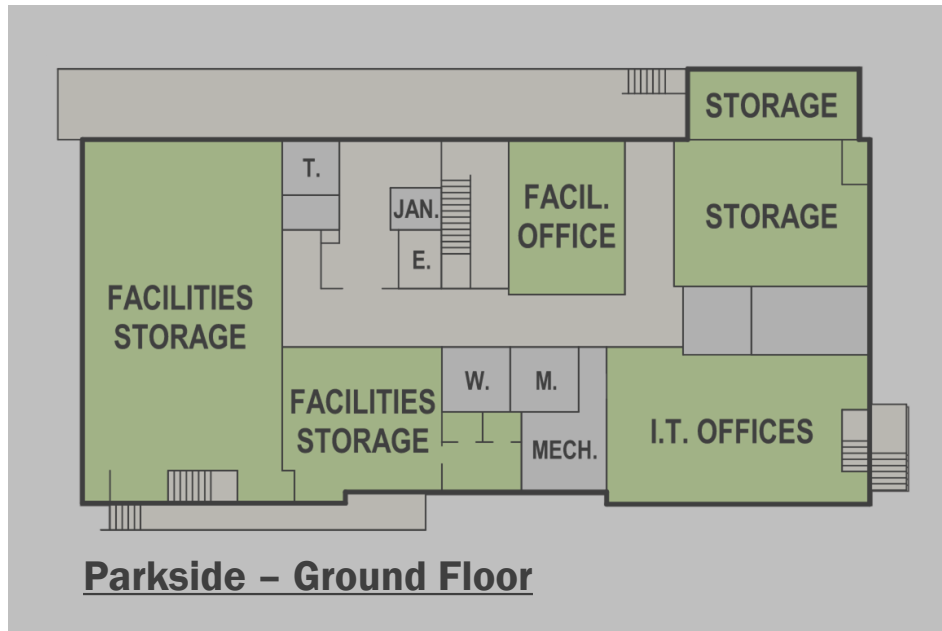

**Parkside - Ground Floor**

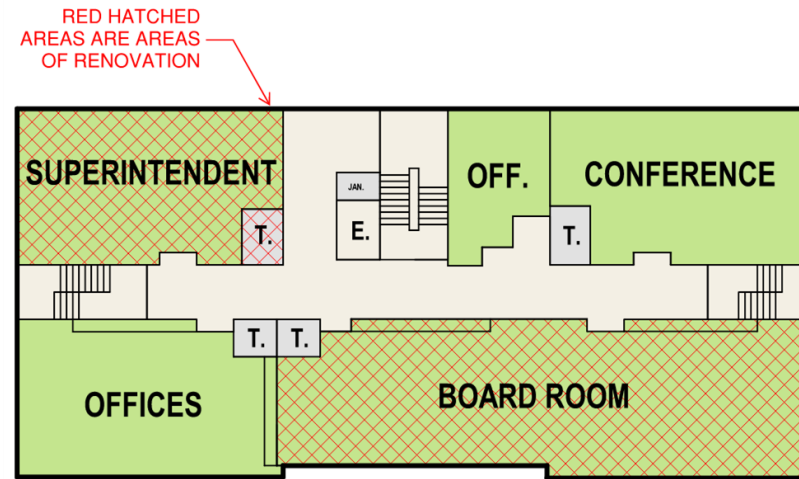

**Parkside - Second Floor**

# LOWER LEVEL

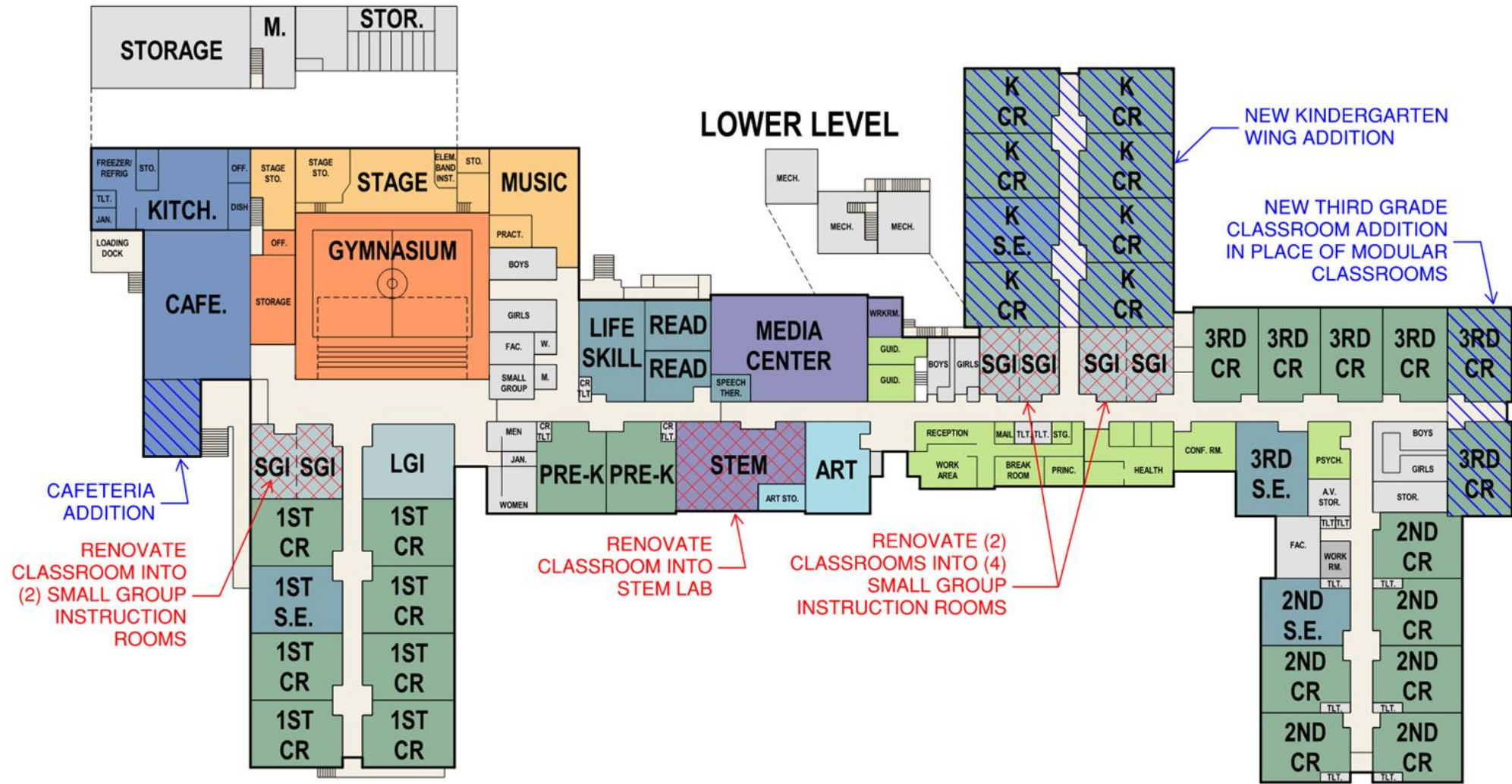

**Towamensing – First Floor**



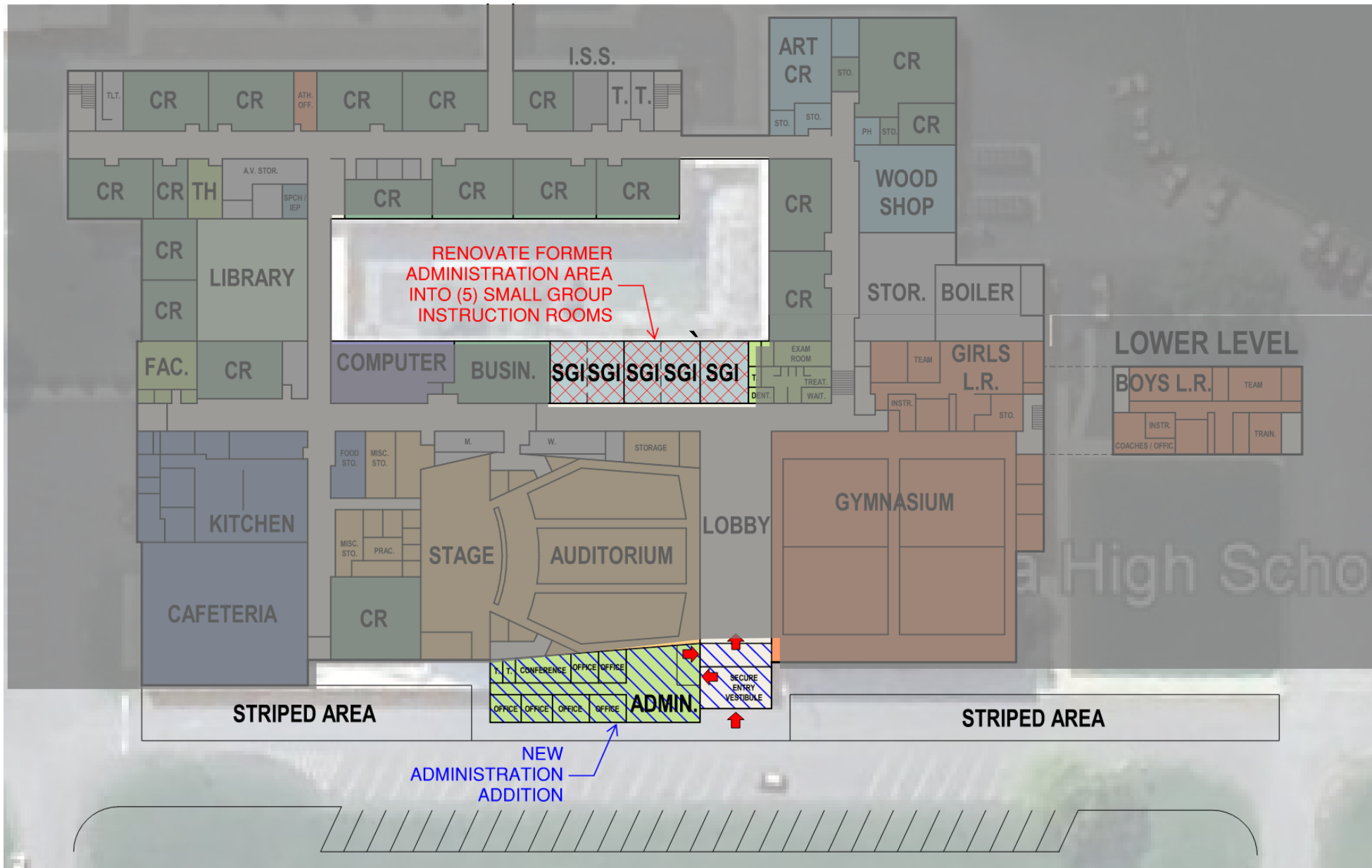





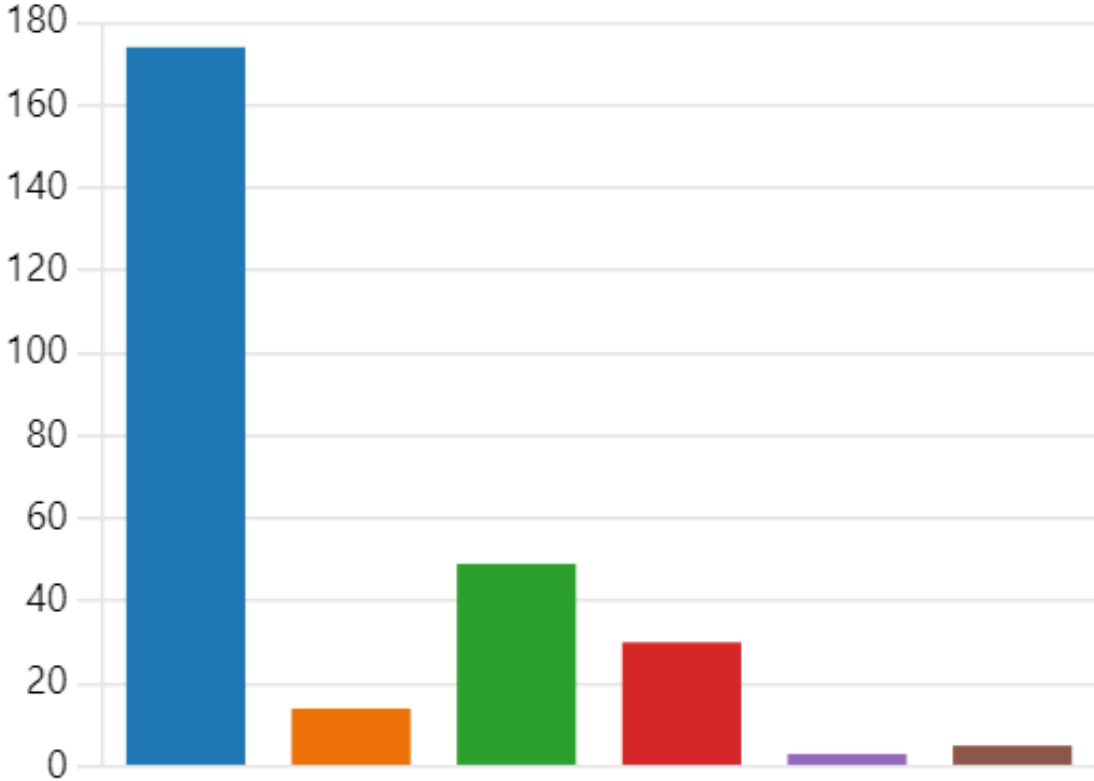

**Senior High School – First Floor**

# 1. What best describes you?

- Parent/Guardian of a current PASD Student
- Parent/Guardian of a future PASD Student
- PASD Resident/Taxpayer with no children attending district schools
- PASD Employee
- PASD Student
- Other



## 2. I currently reside in this PASD Municipality:

	Palmerton Borough	125
	Bowmanstown Borough	13
	Towamensing Township	75
	Lower Towamensing Township	43
	Other	9



# 3. What distinguishes PASD from other school districts:

Academics	98
Performing Arts	32
Athletics	92
Visual Arts	12
Extra-curricular Activities	67
Community Involvement	149
Other	51

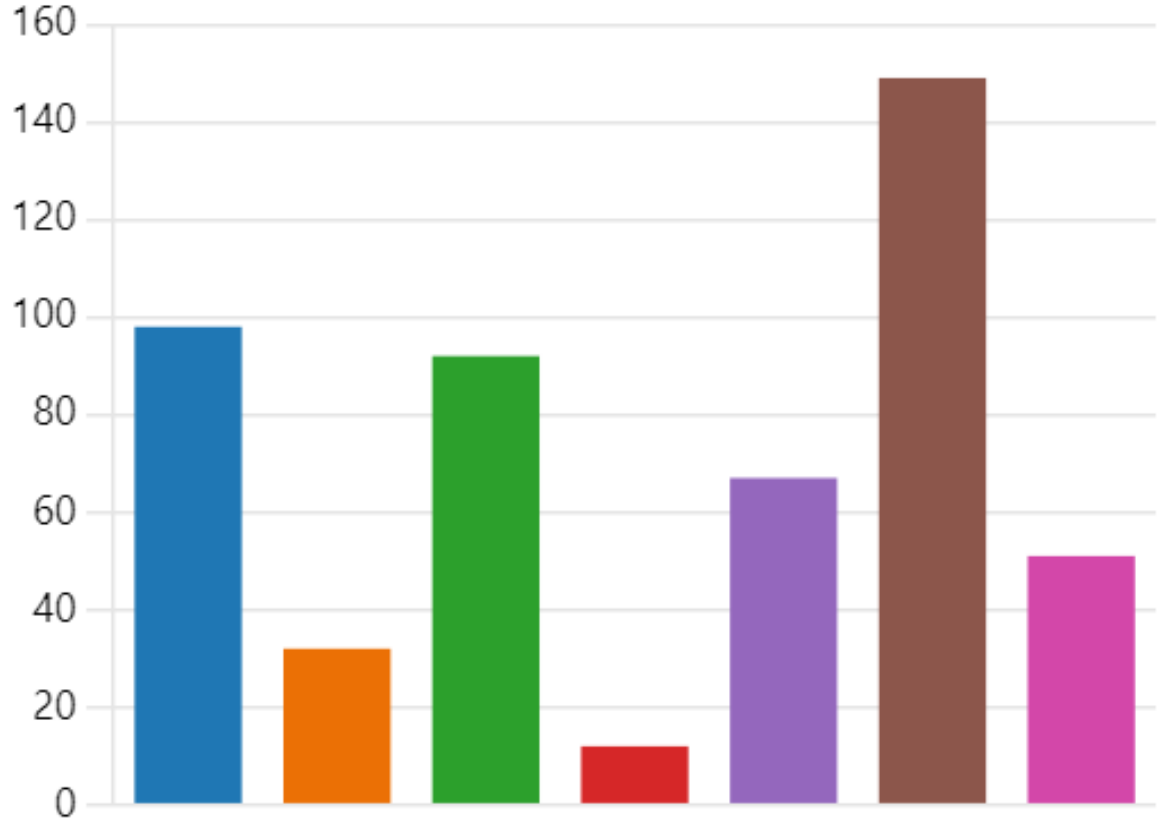

# 4. What do you believe are some of the biggest challenges for PASD moving forward to meet changes in the communities that we serve?

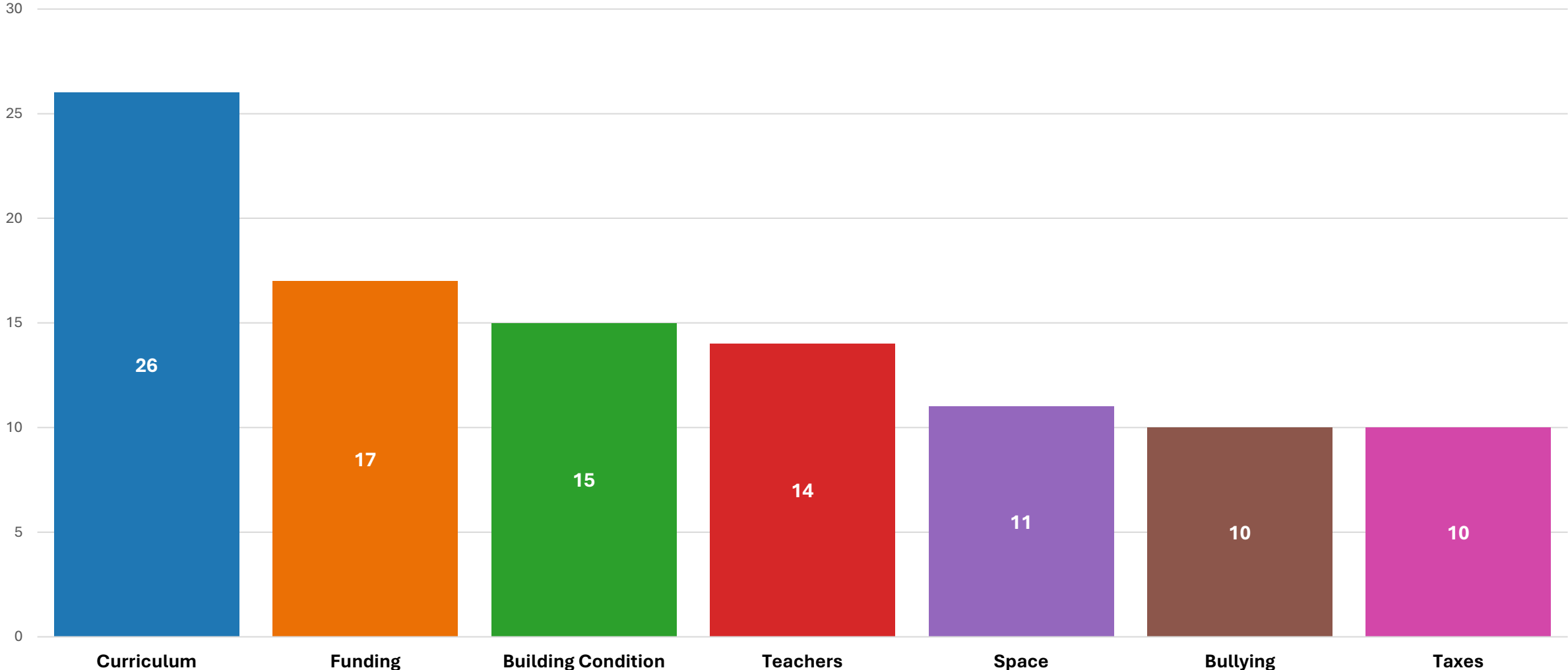

## 5. Knowing that the District funding has limits, please rate the importance of each of the following factors in developing options for the future of PASD schools:

■ Very important   
 ■ Somewhat important   
 ■ Neutral   
 ■ Not very important   
 ■ Not important at all

Community use of PASD athletic facilities

Ensuring consistency of educational programs among the K-6 elementary schools

Realignment of grades at Elementary Buildings to ensure educational efficiency

Improving car & bus traffic flow at building sites (parent/student pick-up and drop-off locations)

Improving student safety and building security

Improving the performance of climate control / air conditioning

Impact of construction projects (new and/or renovations) on property taxes

Designated STEM (Science, technology, engineering, and mathematic) program spaces

Increasing vocational opportunities within the district

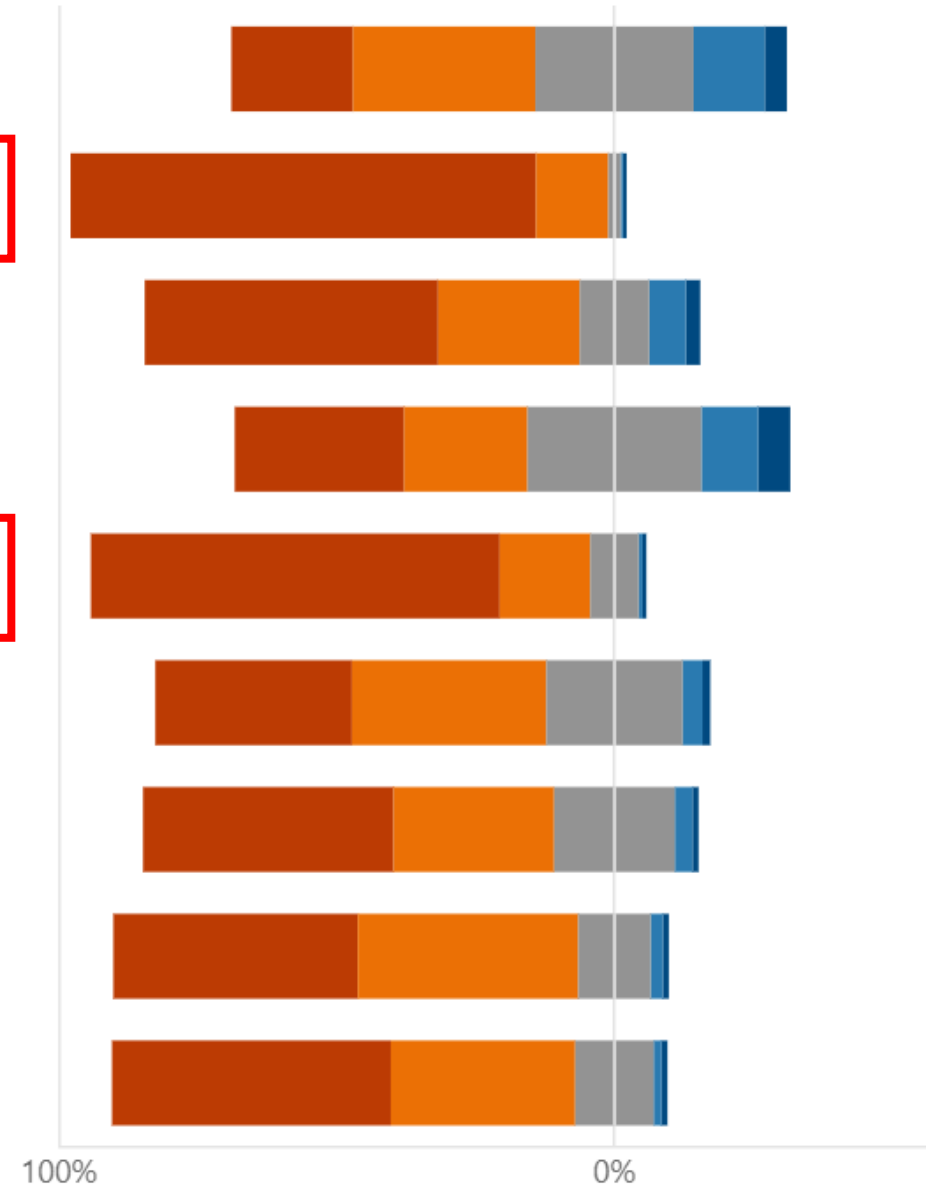

# 6. In your opinion, what is the condition of each school?

■ No Opinion / No Knowledge of the Schools  
 ■ Poor Condition  
 ■ Average Condition  
 ■ Good Condition

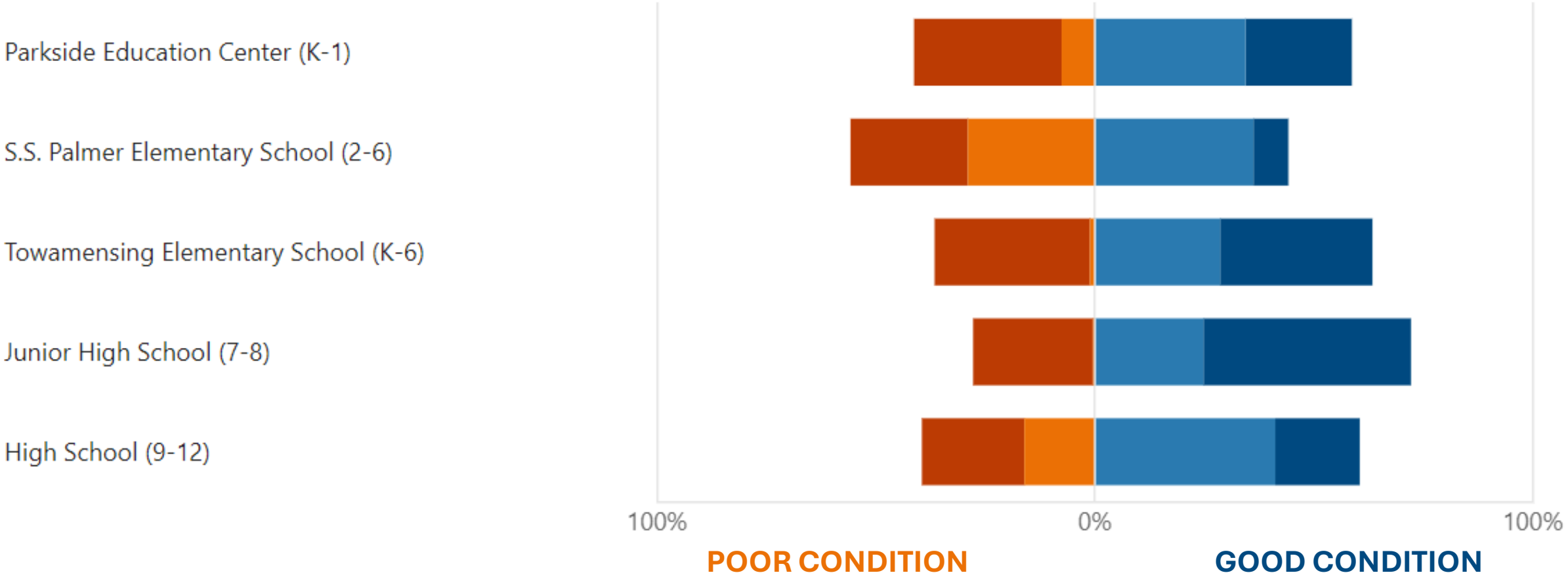

# 7. What athletic facilities should the District address in the Feasibility Study and why?

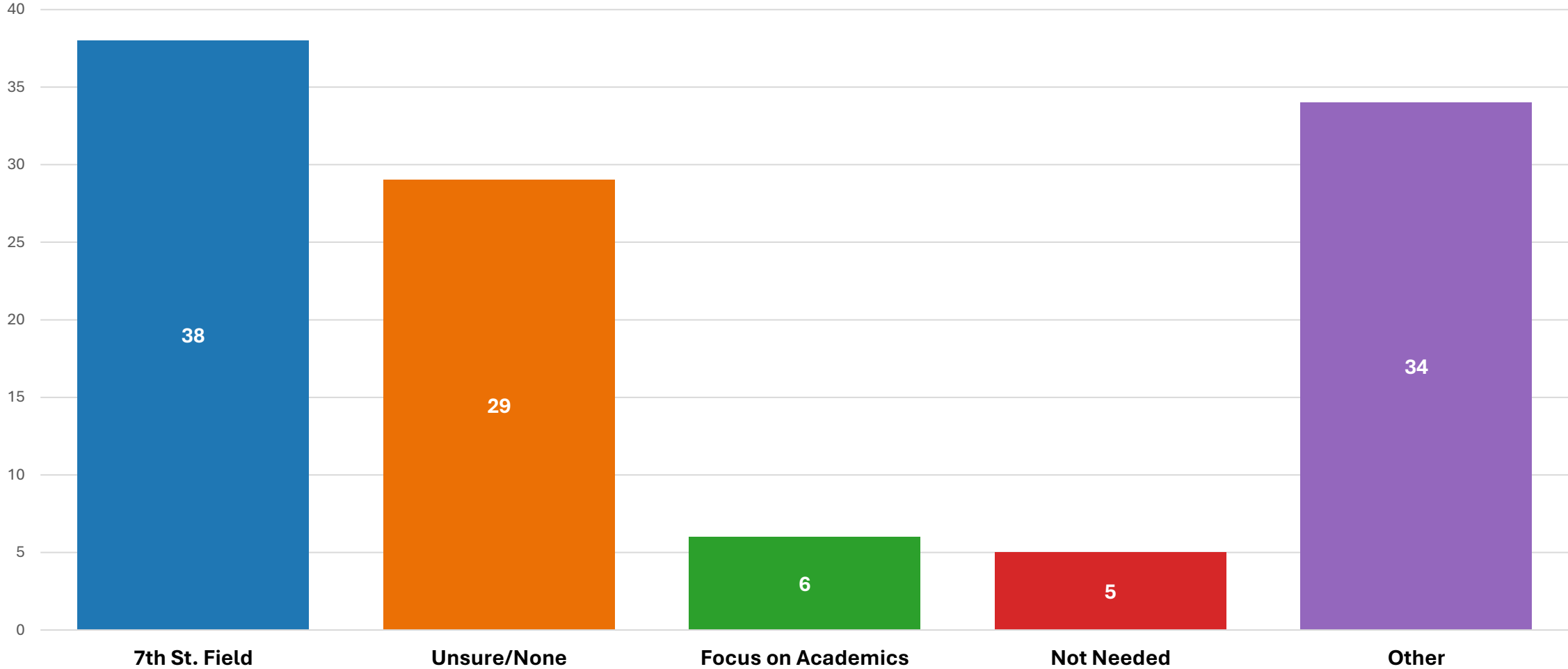



# 8. Our District excels in several academic and extracurricular areas. Which programs do you value the most.

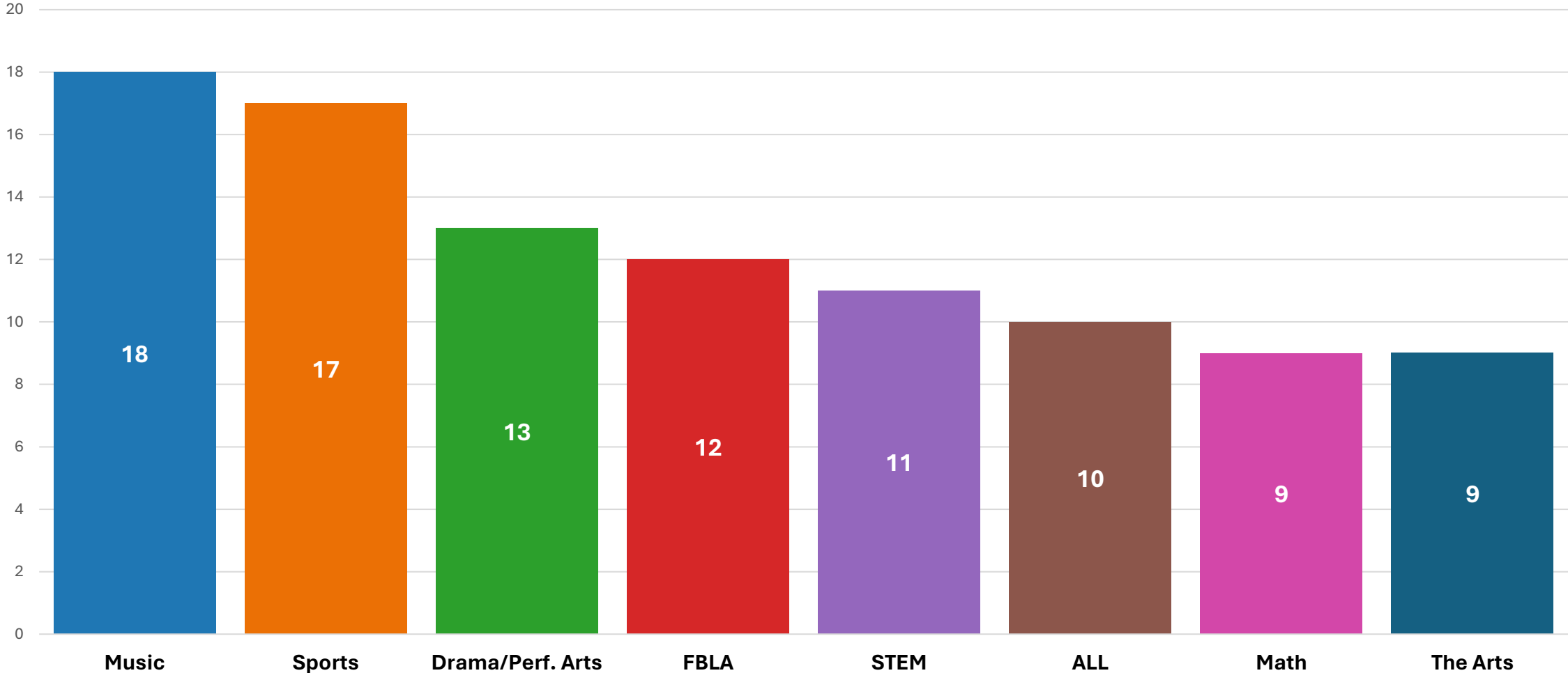

# 9. What types of programs and/or classes would you like to see incorporated into the curriculum in grades 7-12 that are currently not meeting students'/their future employers' needs?

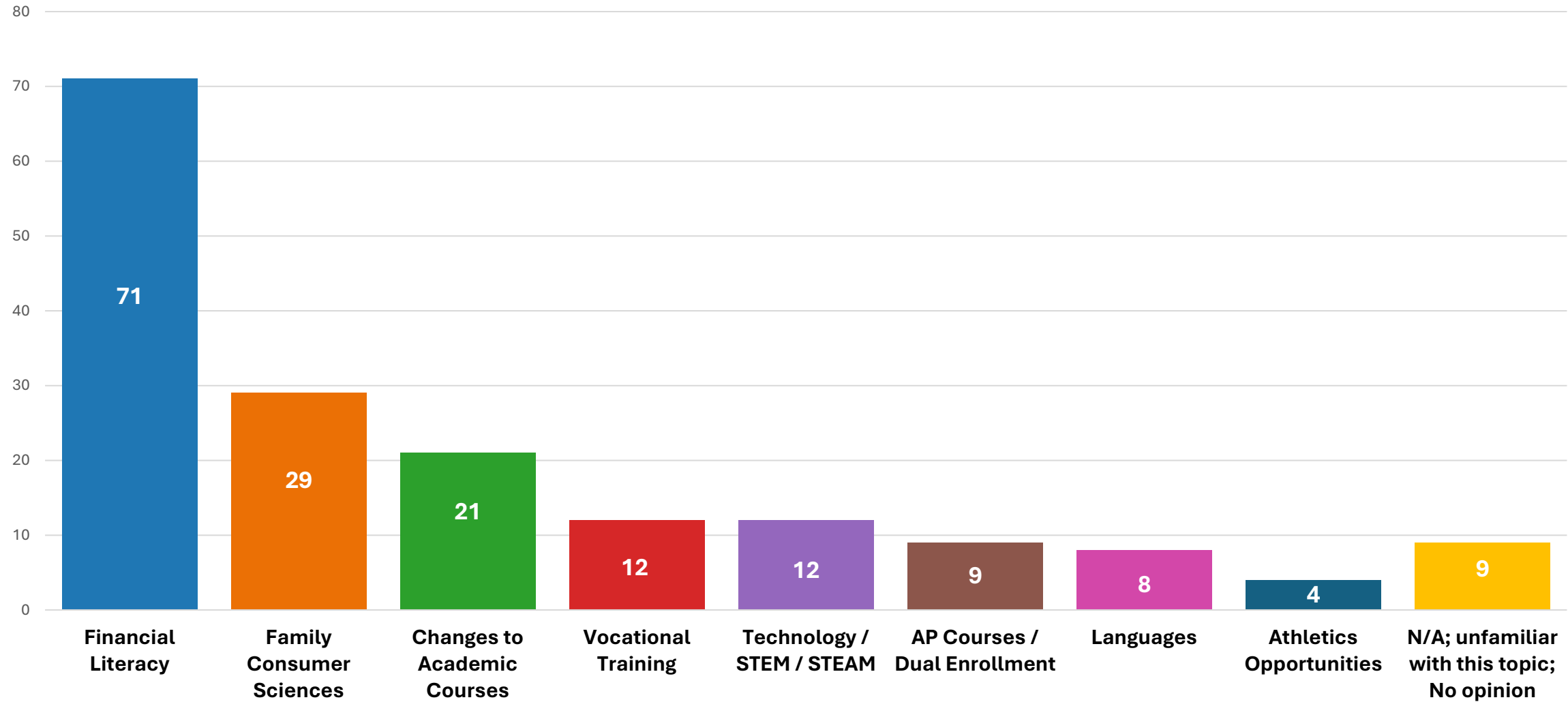

# 10. If this Feasibility Study solves only one issue, what would you like that issue to be?

