



Palmyerton Area High School

January 14, 2025



kcb 
Architects

Tonight's Discussion:

- **Alternative solutions to feasibility study option**
- **Provide additional classrooms on campus**
 - Create room for 6th Grade
- **Relocate high school main entrance**
- **Enhance security**
 - School visitors
 - Gym/Auditorium visitors
- **Consider district office addition at high school**



Challenges:

- Existing high school administration is away from front entry
- Location of front entry not clear from exterior
- Visitor parking should be located near front
- Maintain event entrance at gym/auditorium lobby with security options



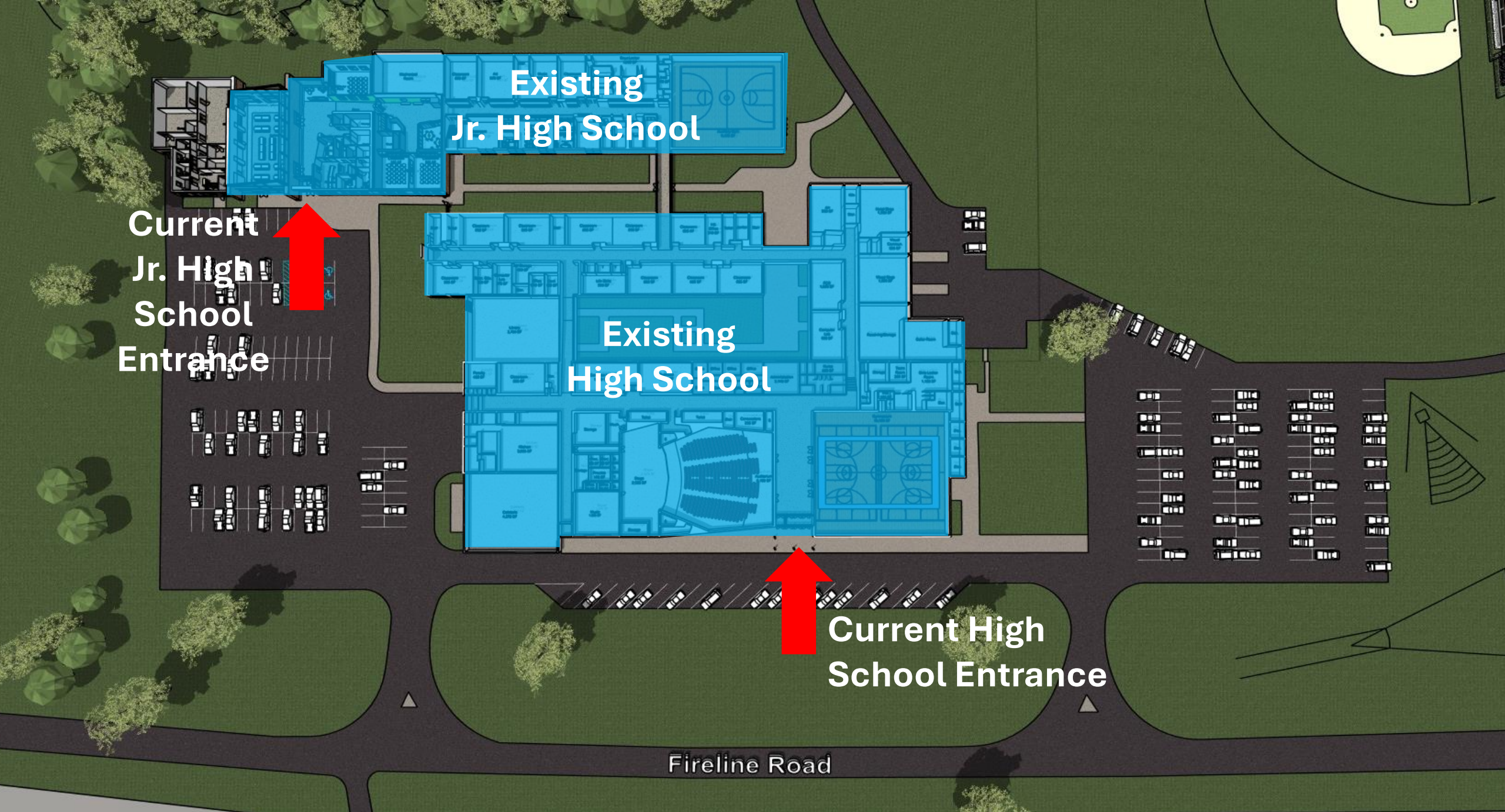

Existing
Jr. High School

Current
Jr. High
School
Entrance

Existing
High School

Current High
School Entrance

Fireline Road

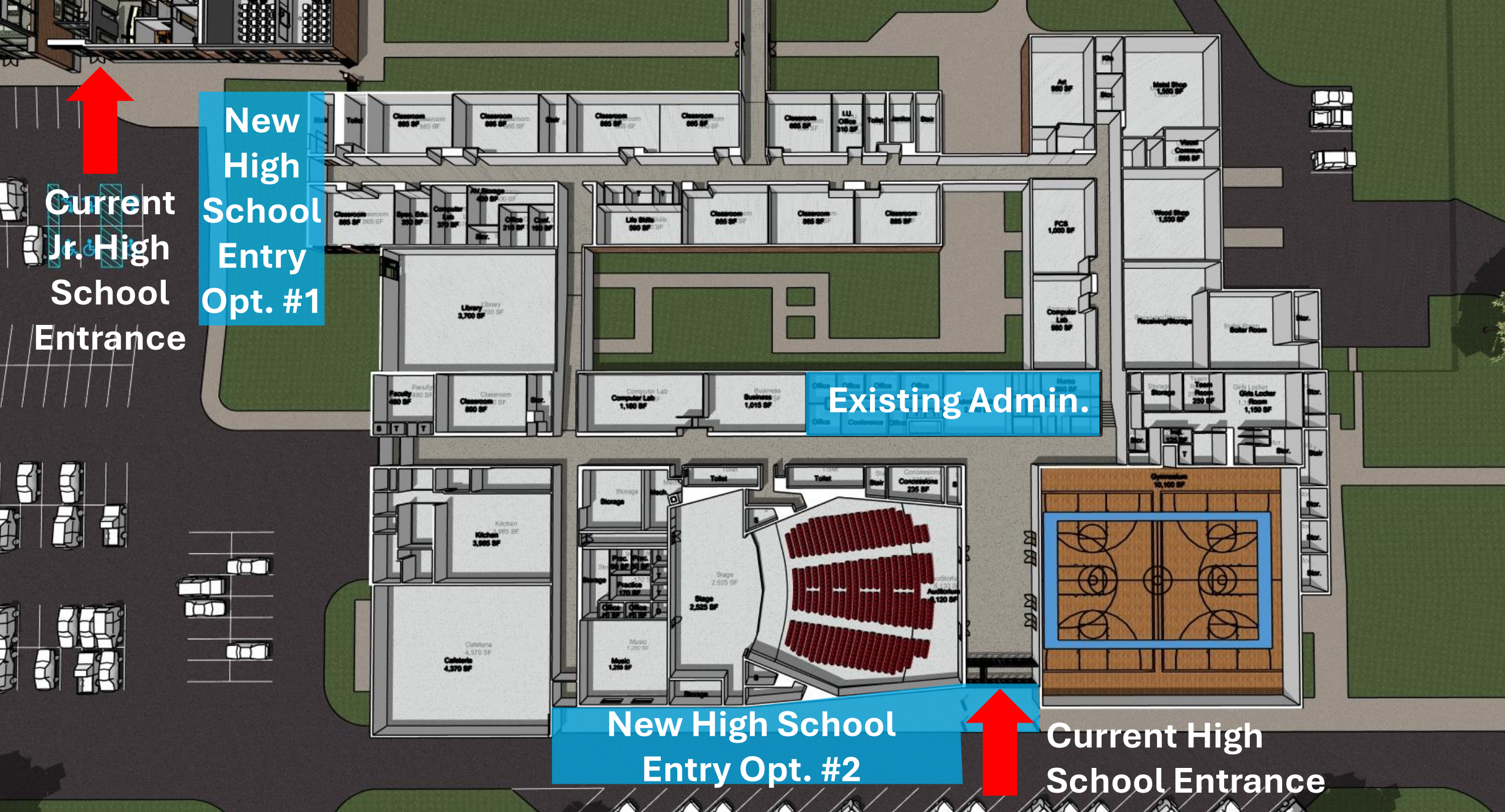

Current Jr. & High School Entrance

New High School Entry Opt. #1

Existing Admin.

New High School Entry Opt. #2

Current High School Entrance



New High School Entry Opt. #1



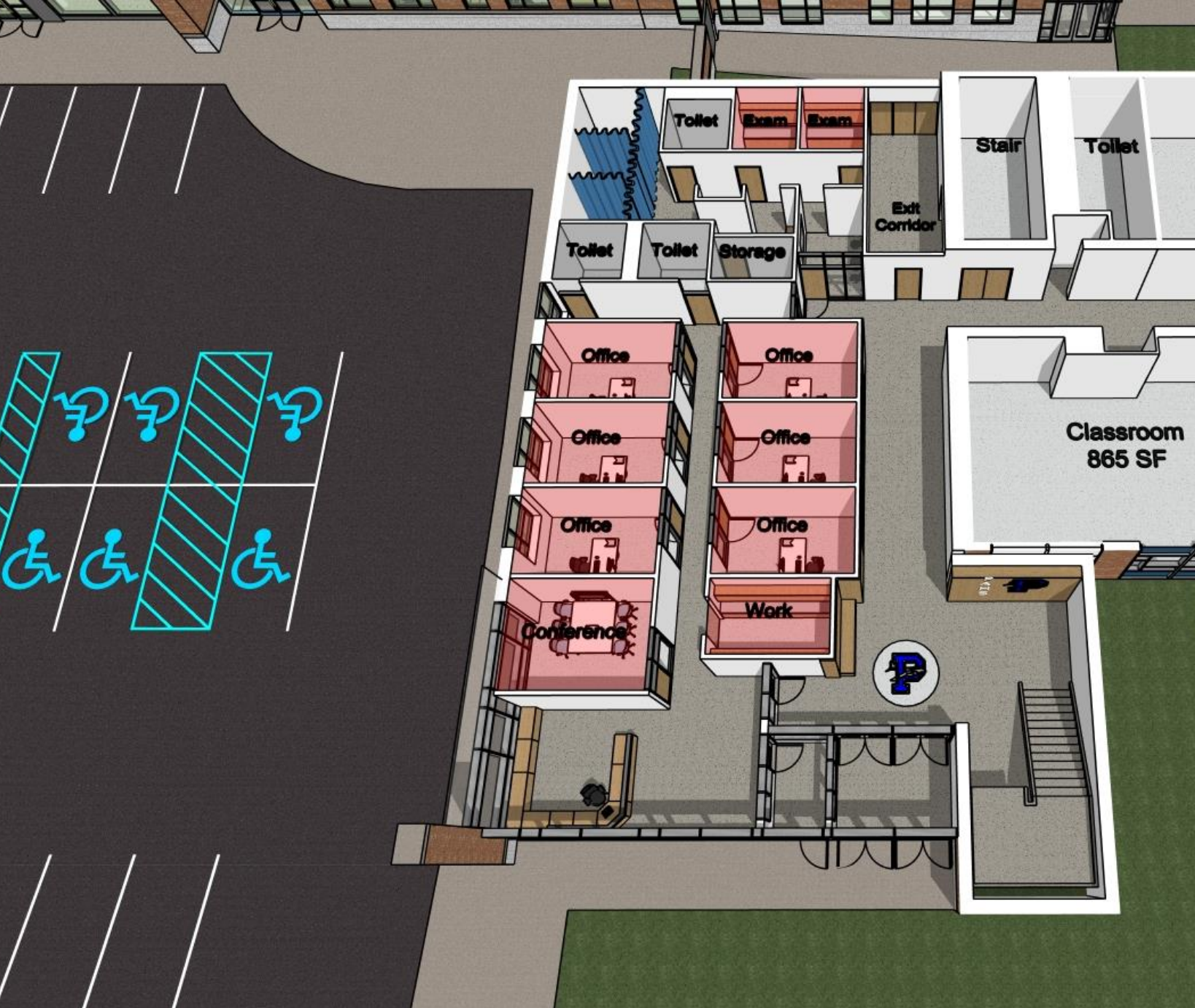

What's Included:

- **New secure main entry vestibule**
- **Admin/reception area**
- **(6) admin. offices**
- **(1) conference room**
- **Nurse's suite**
 - Toilet rooms
 - Exam rooms
 - Cot area
 - Storage

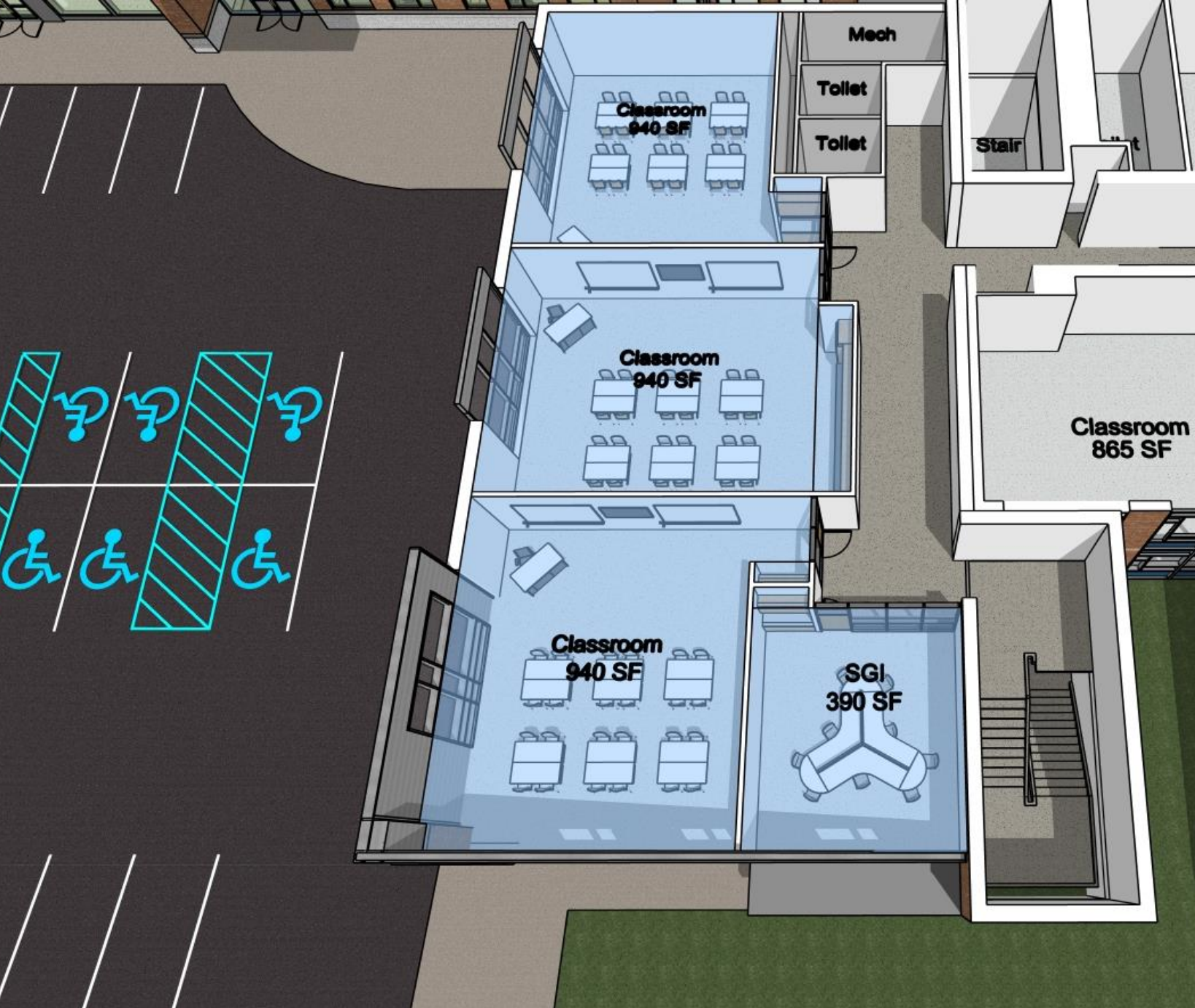

What's Included:

- (3) new classrooms
- (1) Small Group Instruction room
 - Learning support for 8-10 students
- (2) toilet rooms
- New fire stair

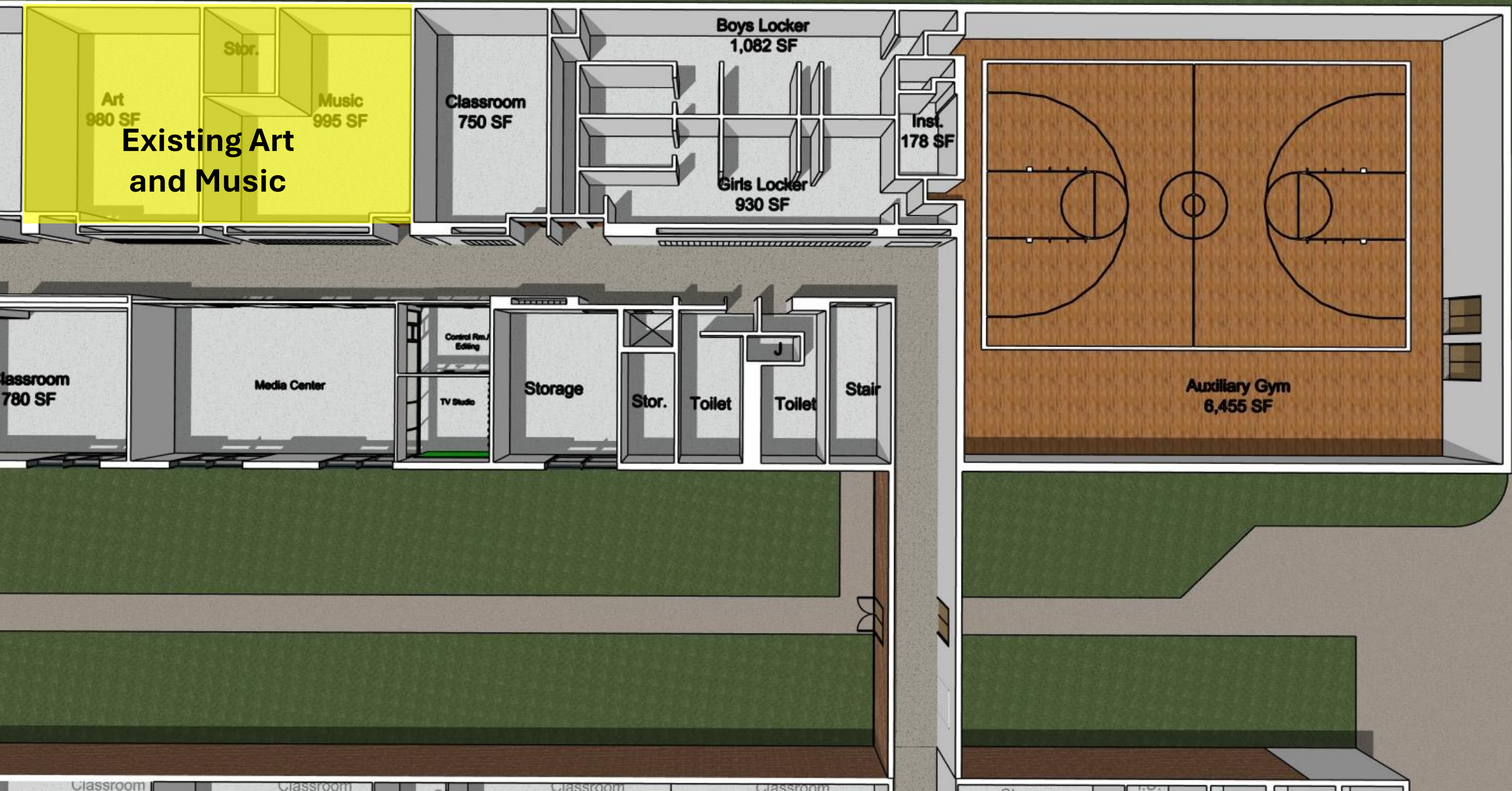

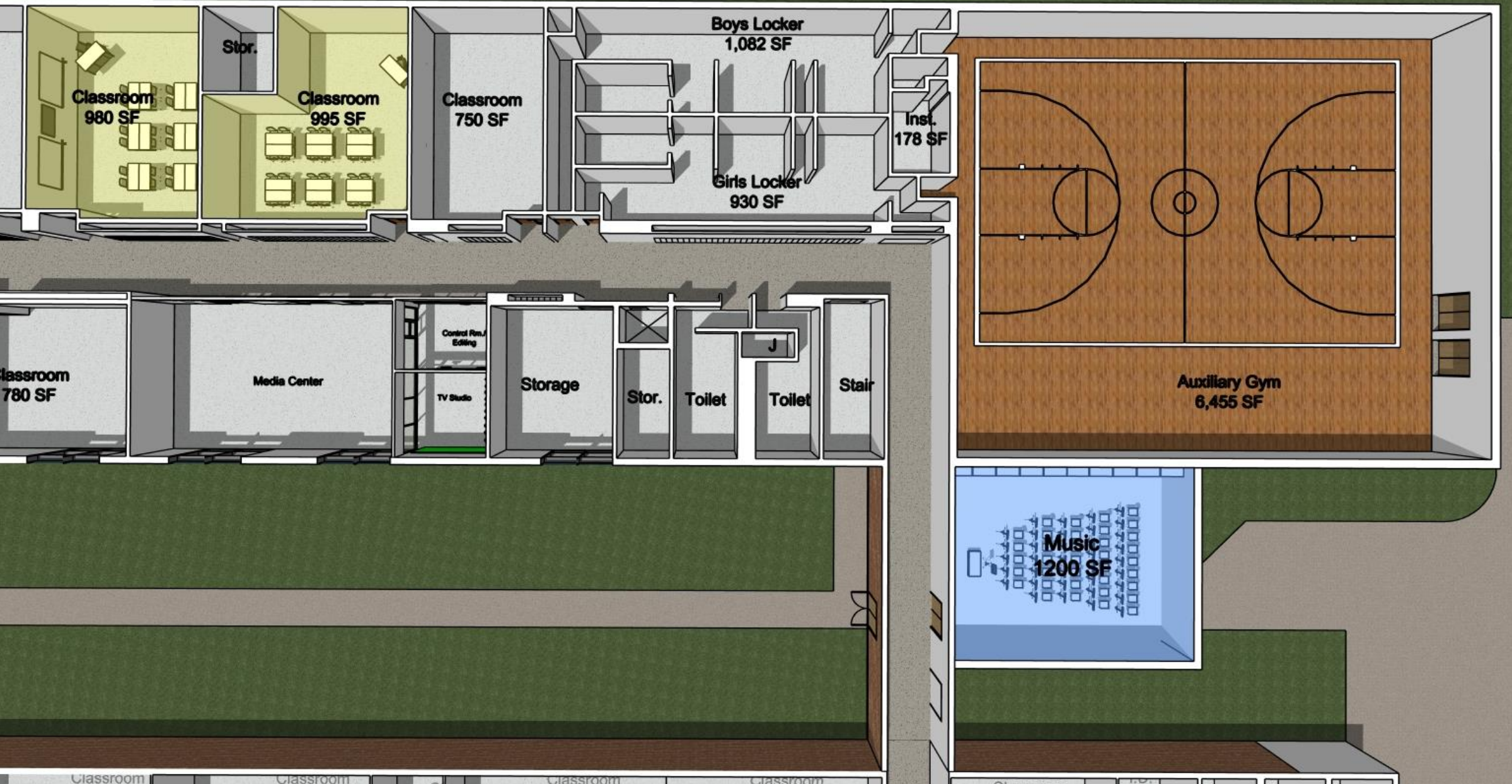

What's Included:

- (2) new large classrooms
- Spaces could be devoted to Art and Music to accommodate additional middle school students



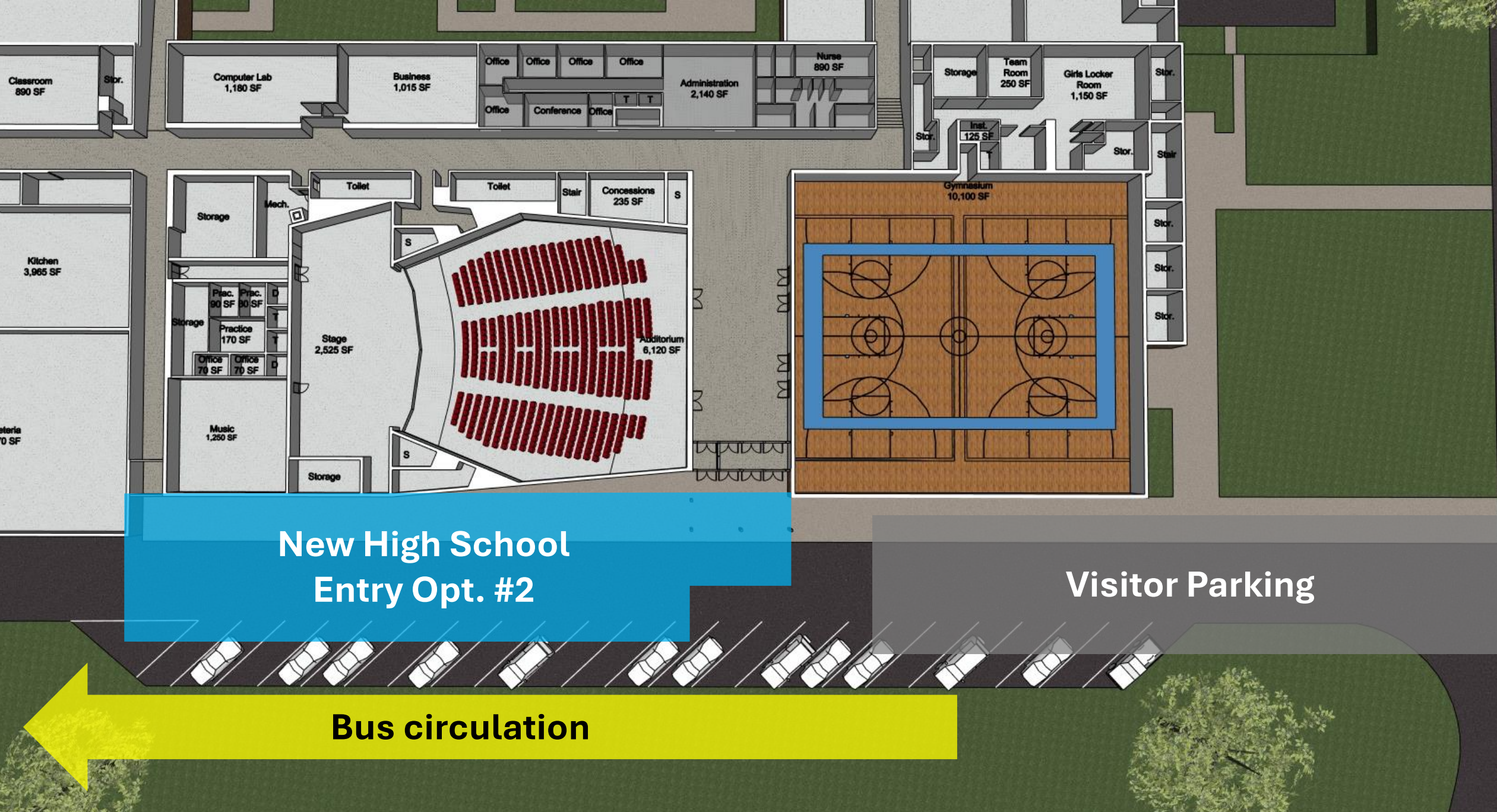

**New High School
Entry Opt. #2**

Visitor Parking

Bus circulation

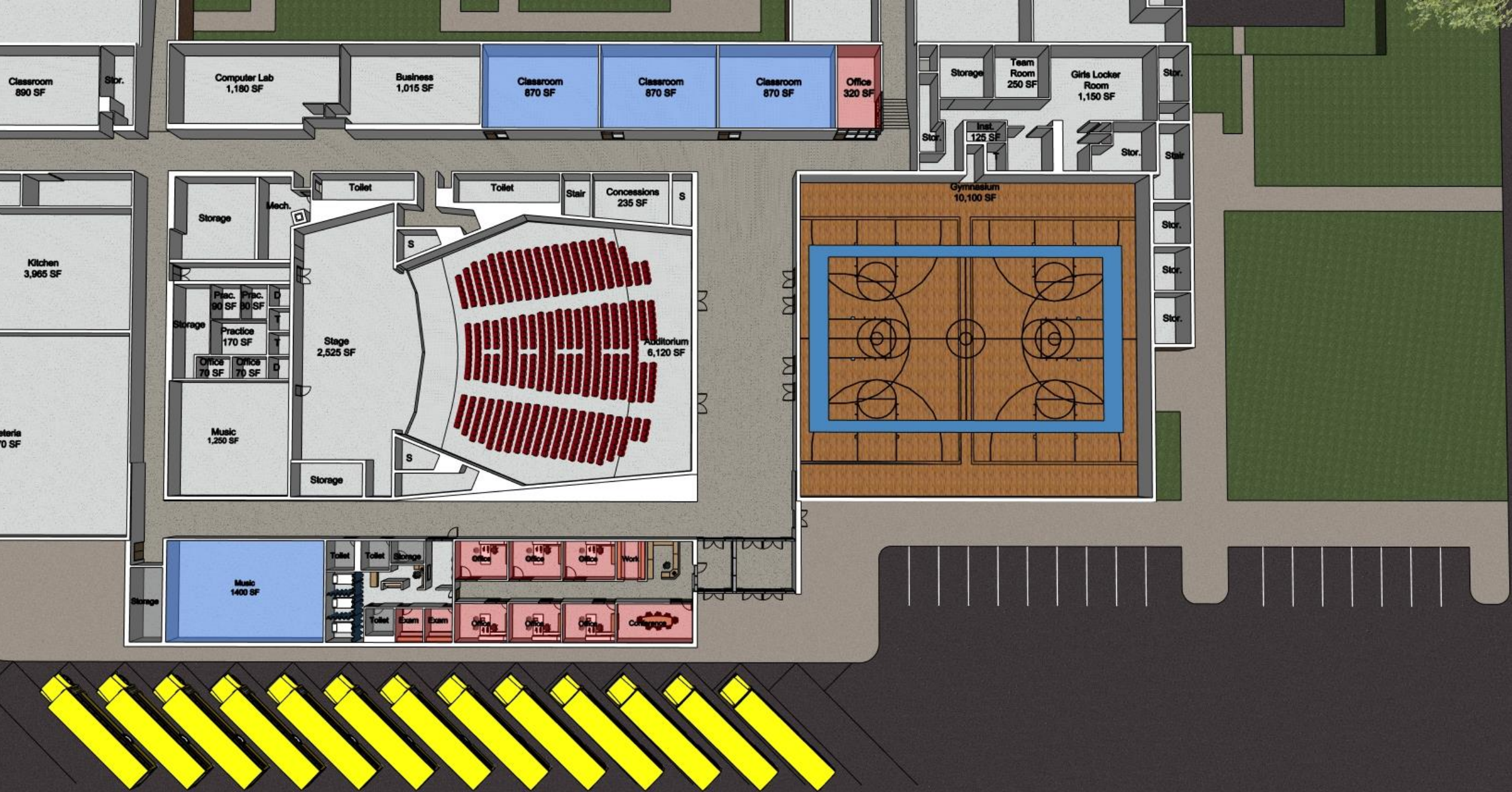

What's Included:

- New secure main entry vestibule
- (1) new band room

- Admin/reception area
- (6) admin. offices
- (1) conference room

- Nurse's suite
 - Toilet rooms
 - Exam rooms
 - Cot area
 - Storage

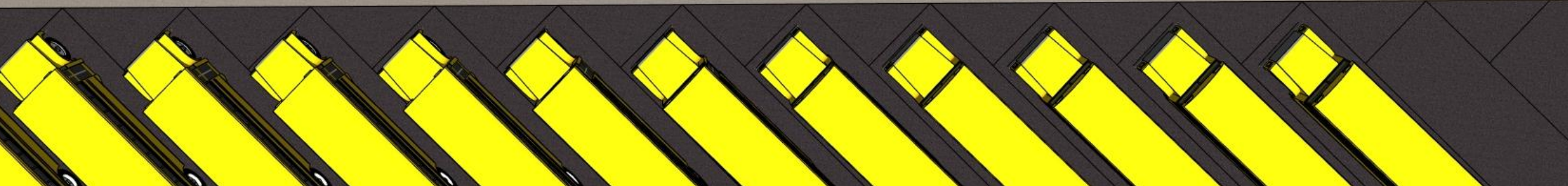
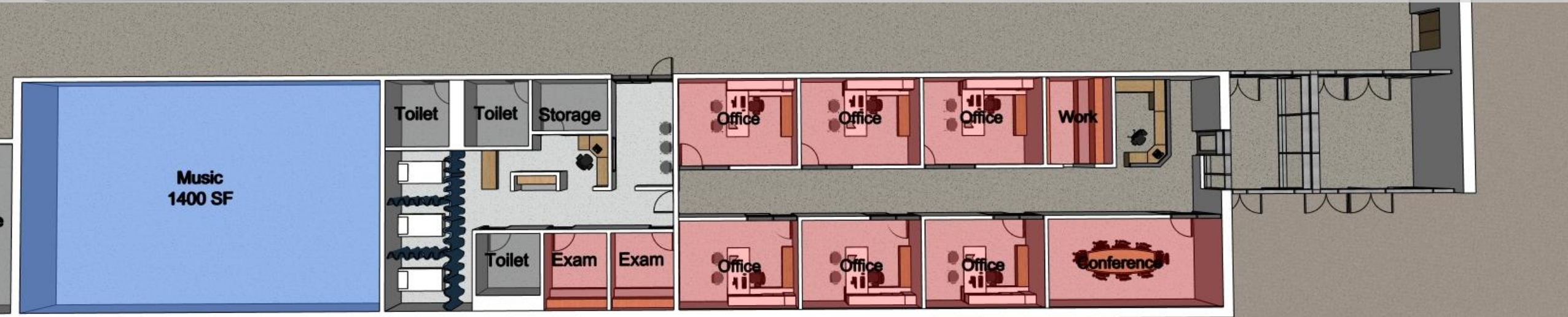



Stair

Toilet

Classroom
865 SF

Classroom
865 SF

Stair

Classroom
865 SF

Classroom
865 SF

Spec. Edu.
350 SF

Computer
Lab
370 SF

AV Storage
400 SF

Stor.

Office
215 SF

Conf.
190 SF

Library
3,700 SF





What's Included:

- **(6) new classrooms**
- **(2) Small Group Instruction room**
 - Learning support for 8-10 students
- **(4) toilet rooms**
- **New fire stair**

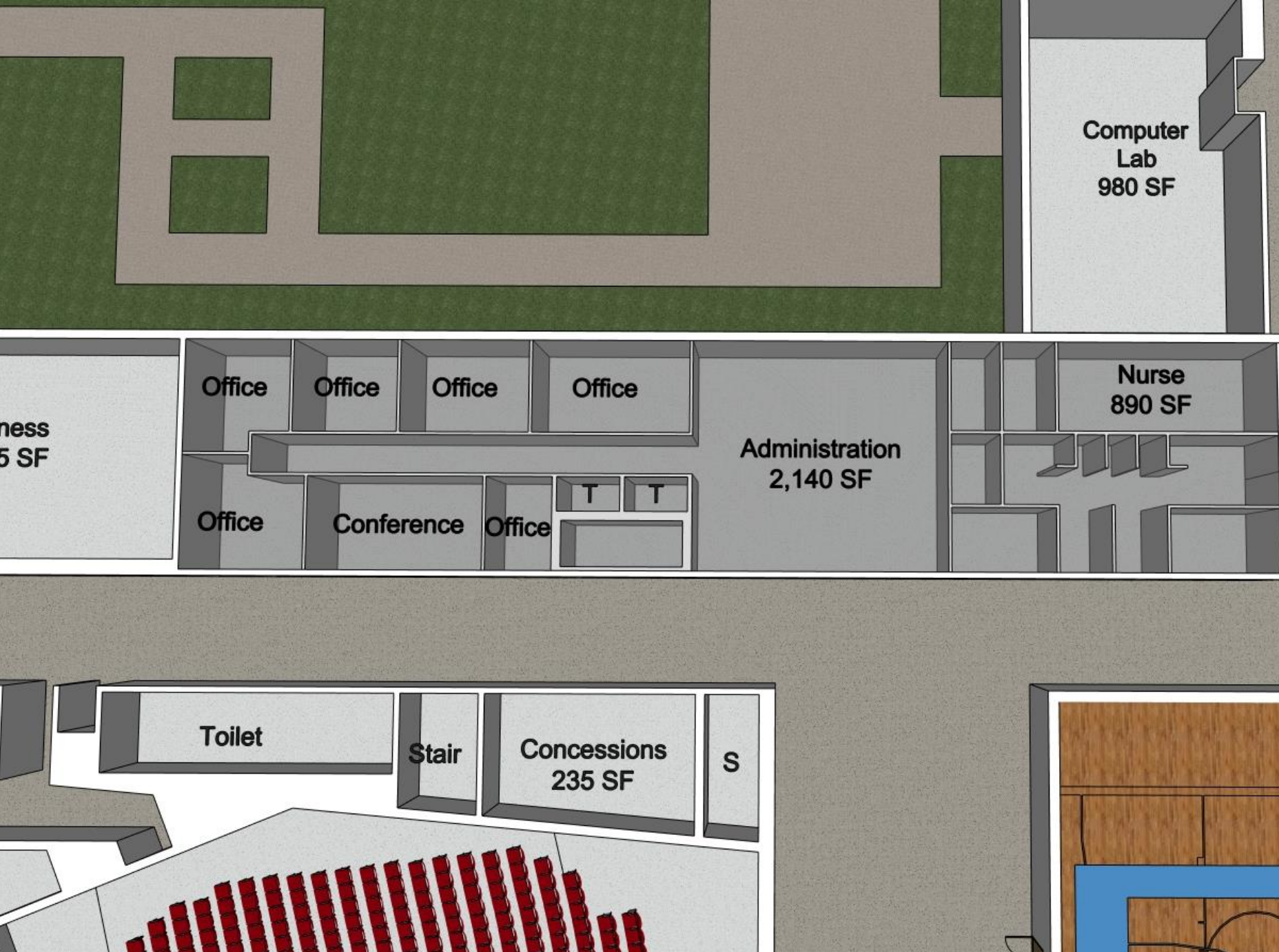

What's Existing:

- (6) admin. offices
- (1) conference room
- Nurse's suite

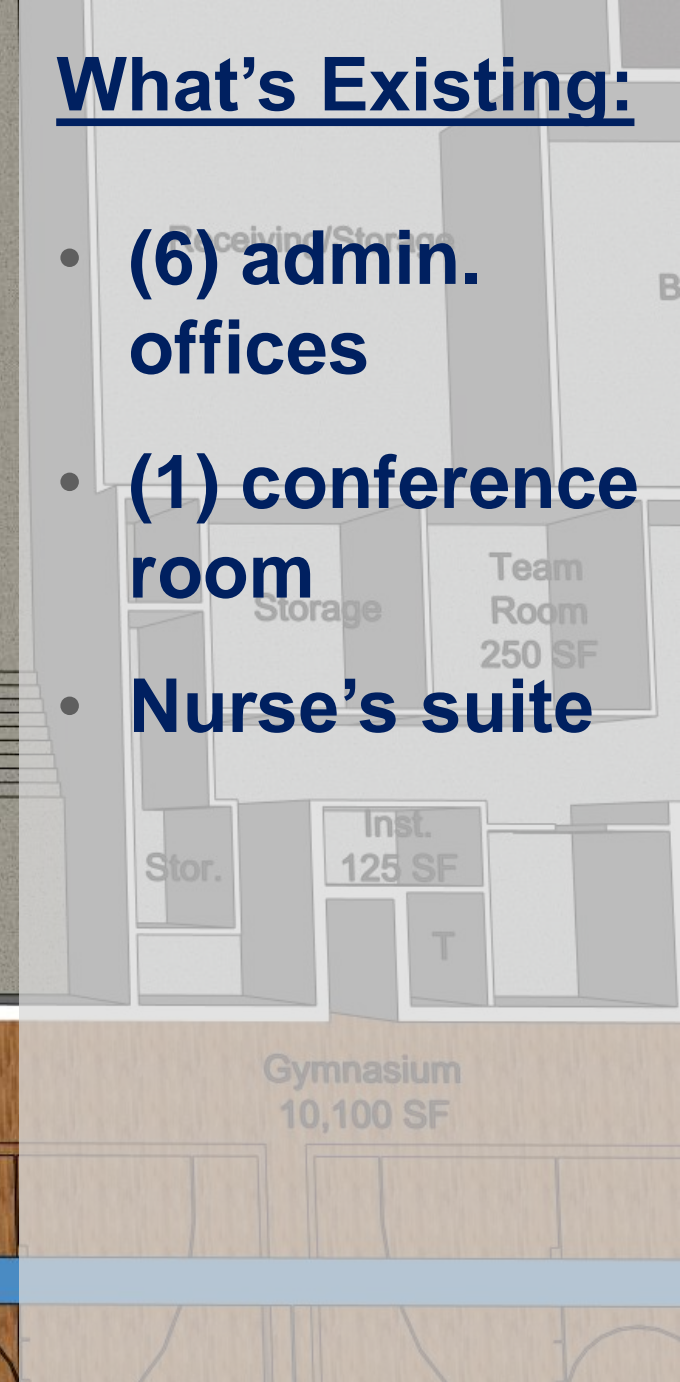

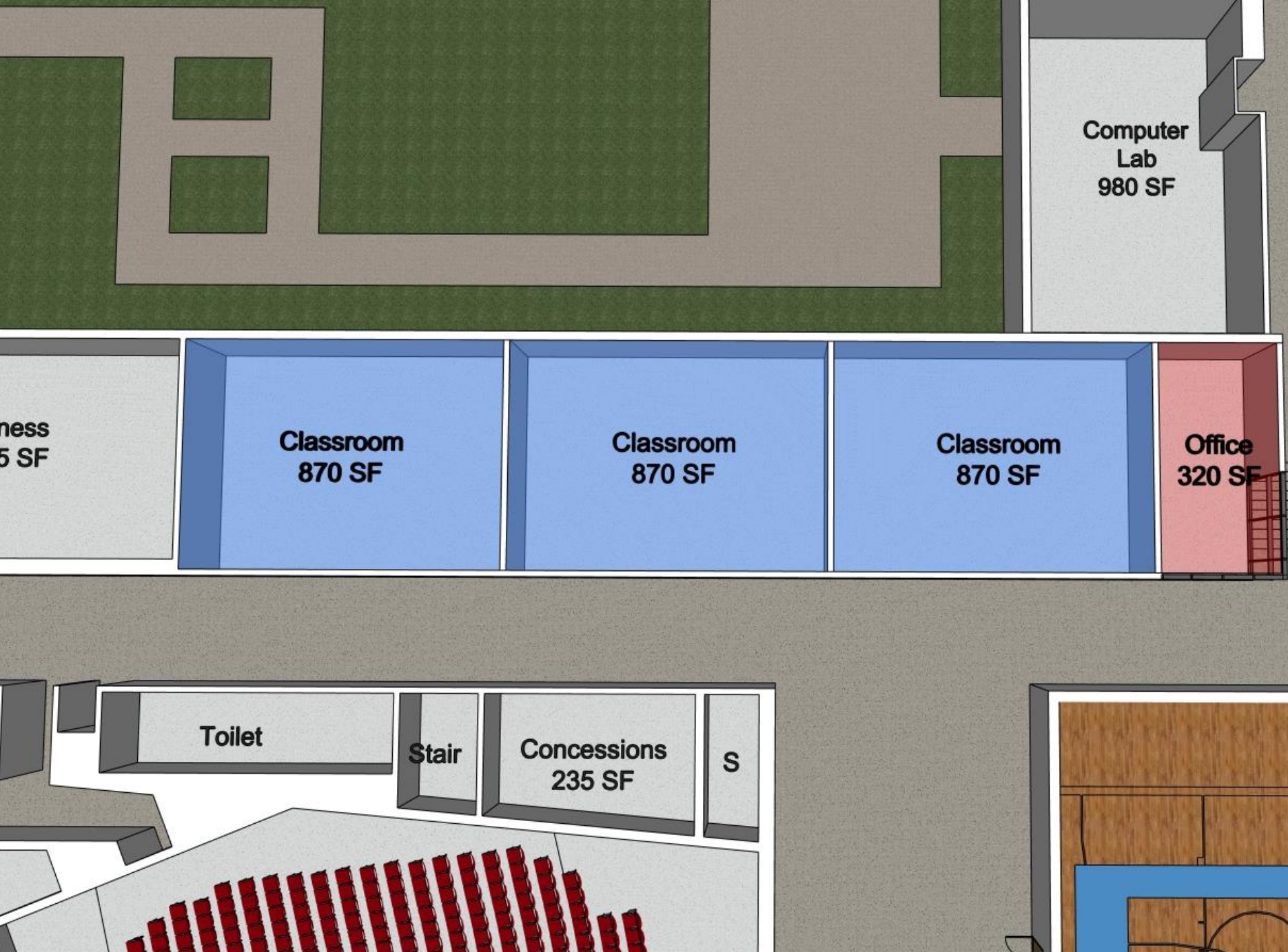

What's Included:

- (3) new classrooms
- (1) assistant principal's office

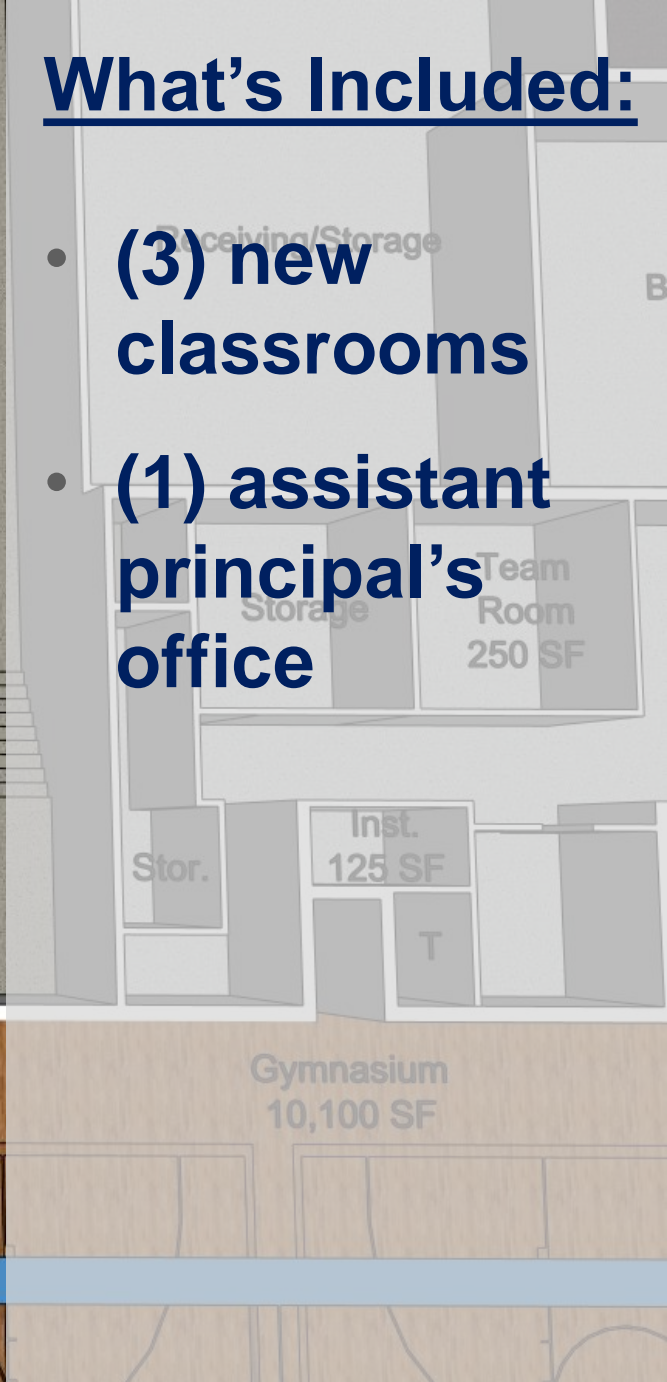

Option #1 (8 classrooms gained):

- Entrance near Jr. High entrance
- 3 classrooms on second floor
- 2 additional classrooms at link
- Total new construction = 13,650sf
- Total project budget = \$10.3m



Option #2 (10 classrooms gained):

- Entrance along Fireline Road
- 6 new classrooms near Jr. High
- New band/music room
- Total new construction = 18,800sf
- Total project budget = \$13.4m

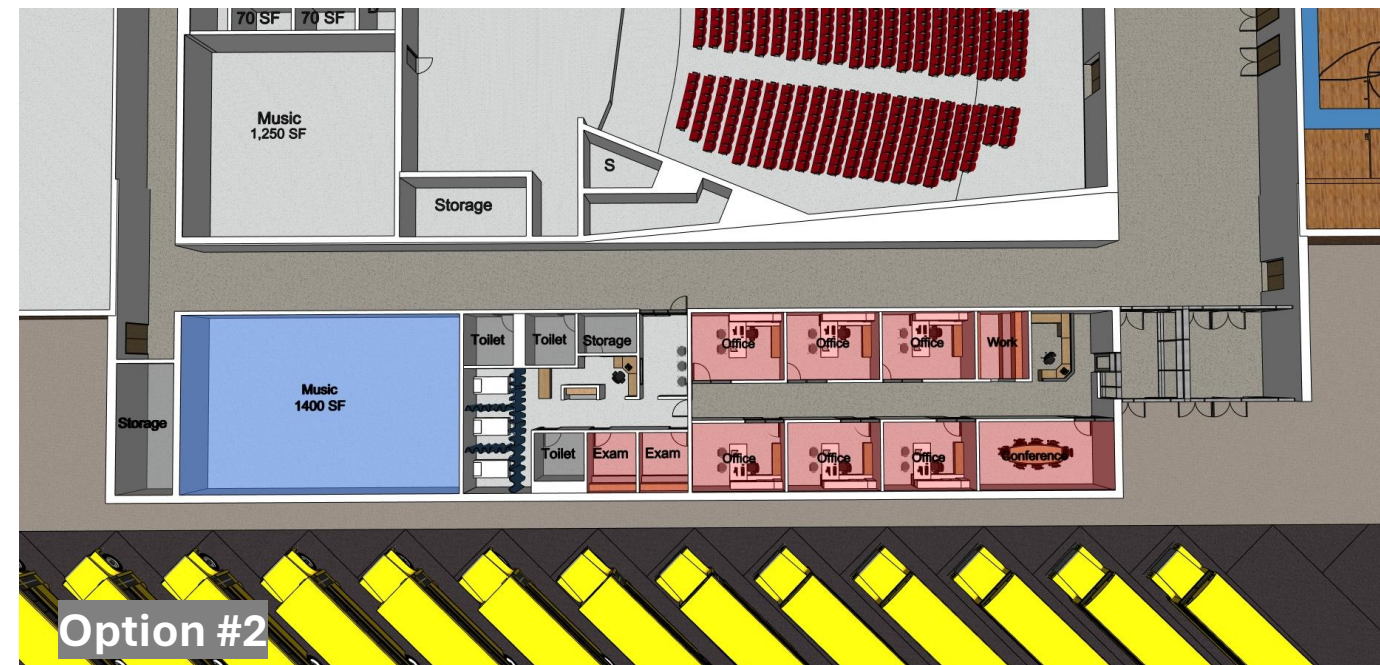

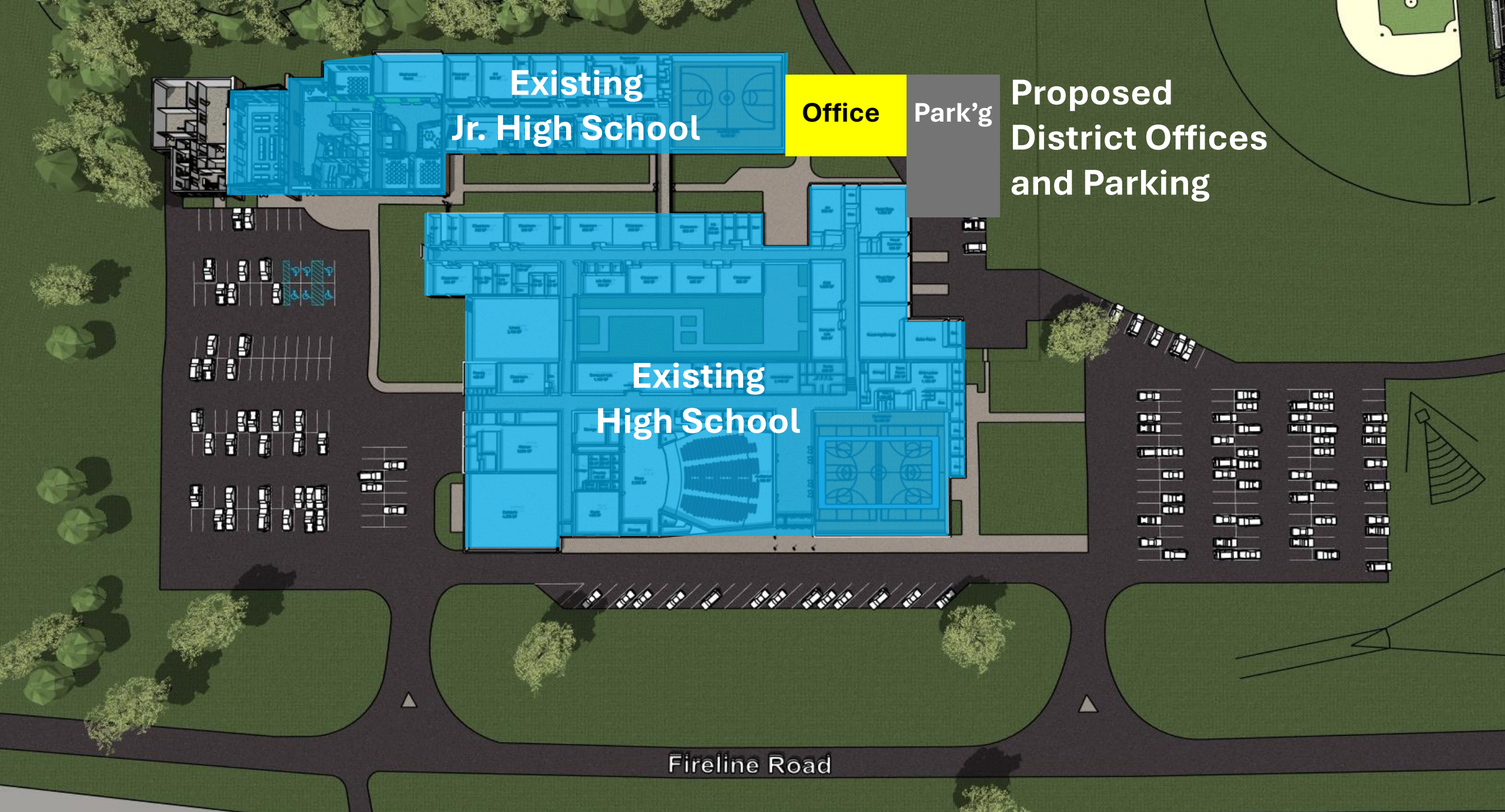

Existing
Jr. High School

Office

Park'g

Proposed
District Offices
and Parking

Existing
High School

Fireline Road



Auxiliary Gym
6,455 SF
Auxiliary Gym
6,455 SF

Art
960 SF

Kiln

Metal Shop
1,550 SF

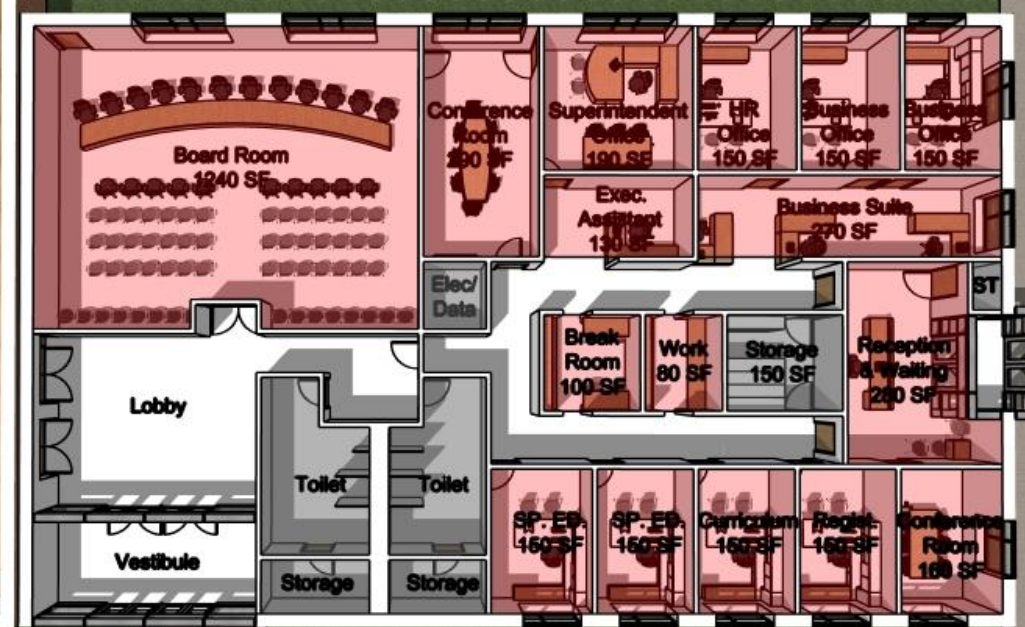
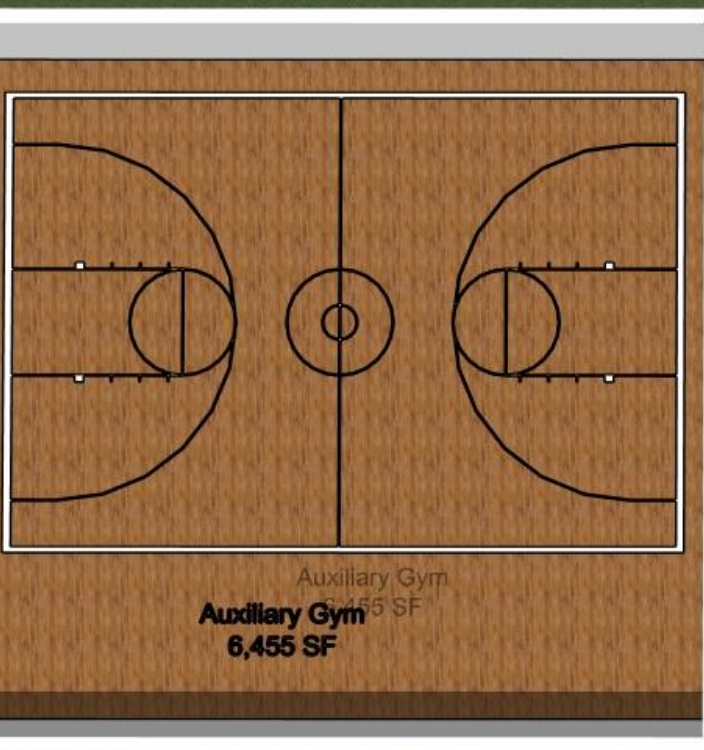

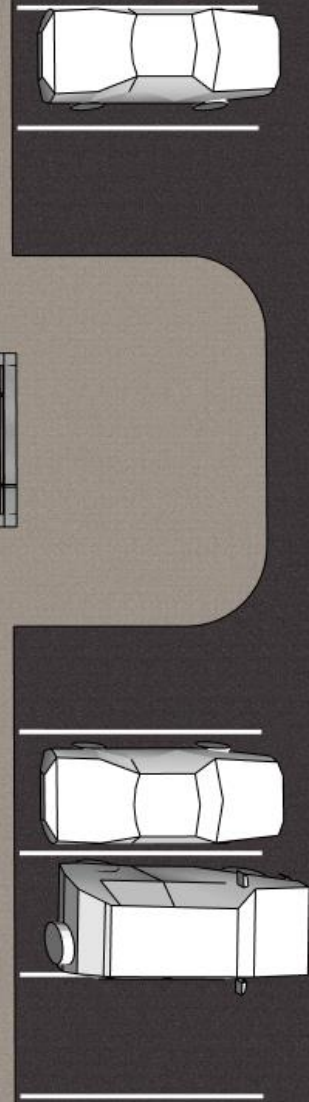
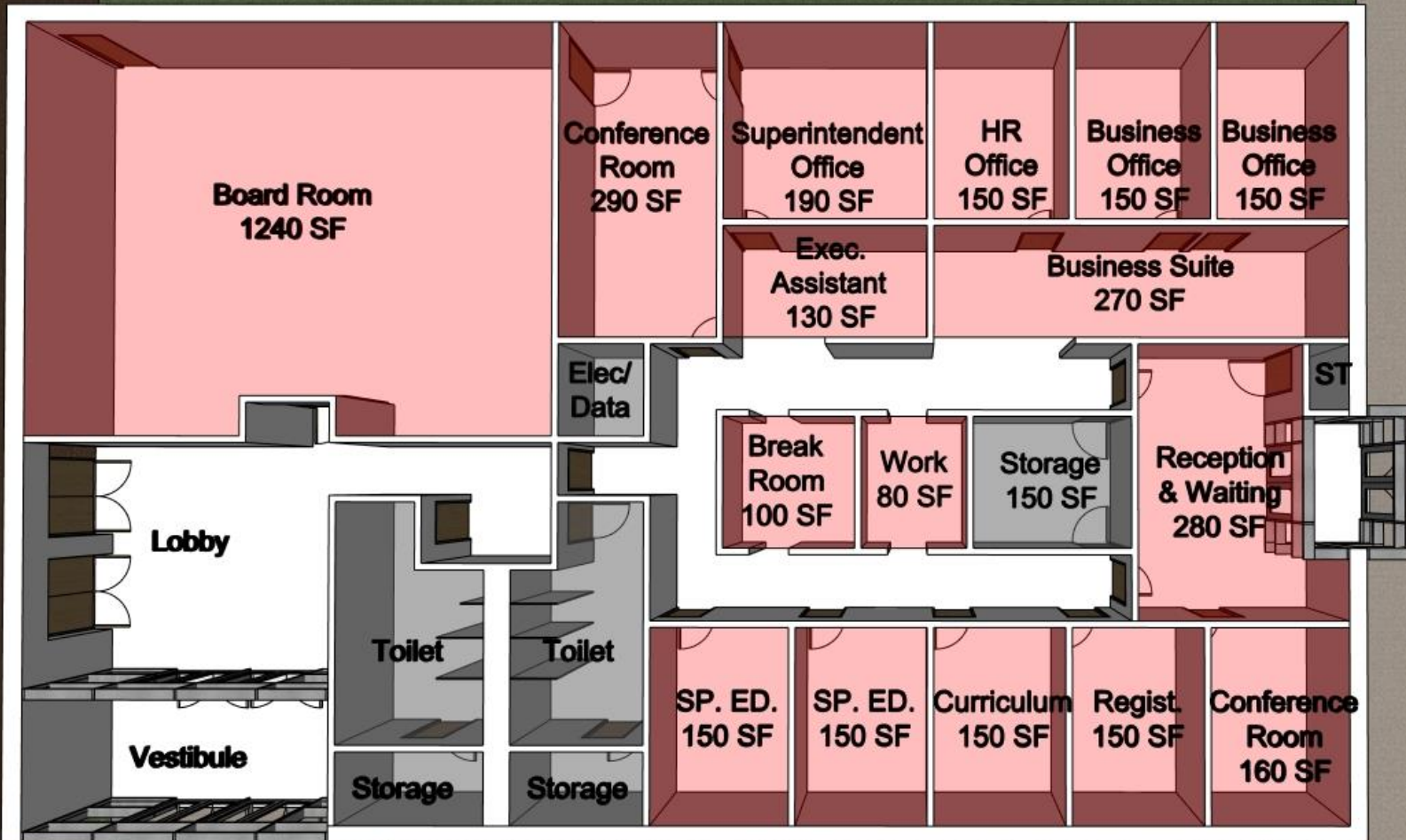

What's Included:

- **Offices similar to Parkside**
- **New Board Rm**
- **Shared entry to aux. gym with toilet rms**
- **6650sf new construction**
- **\$4m project budget**

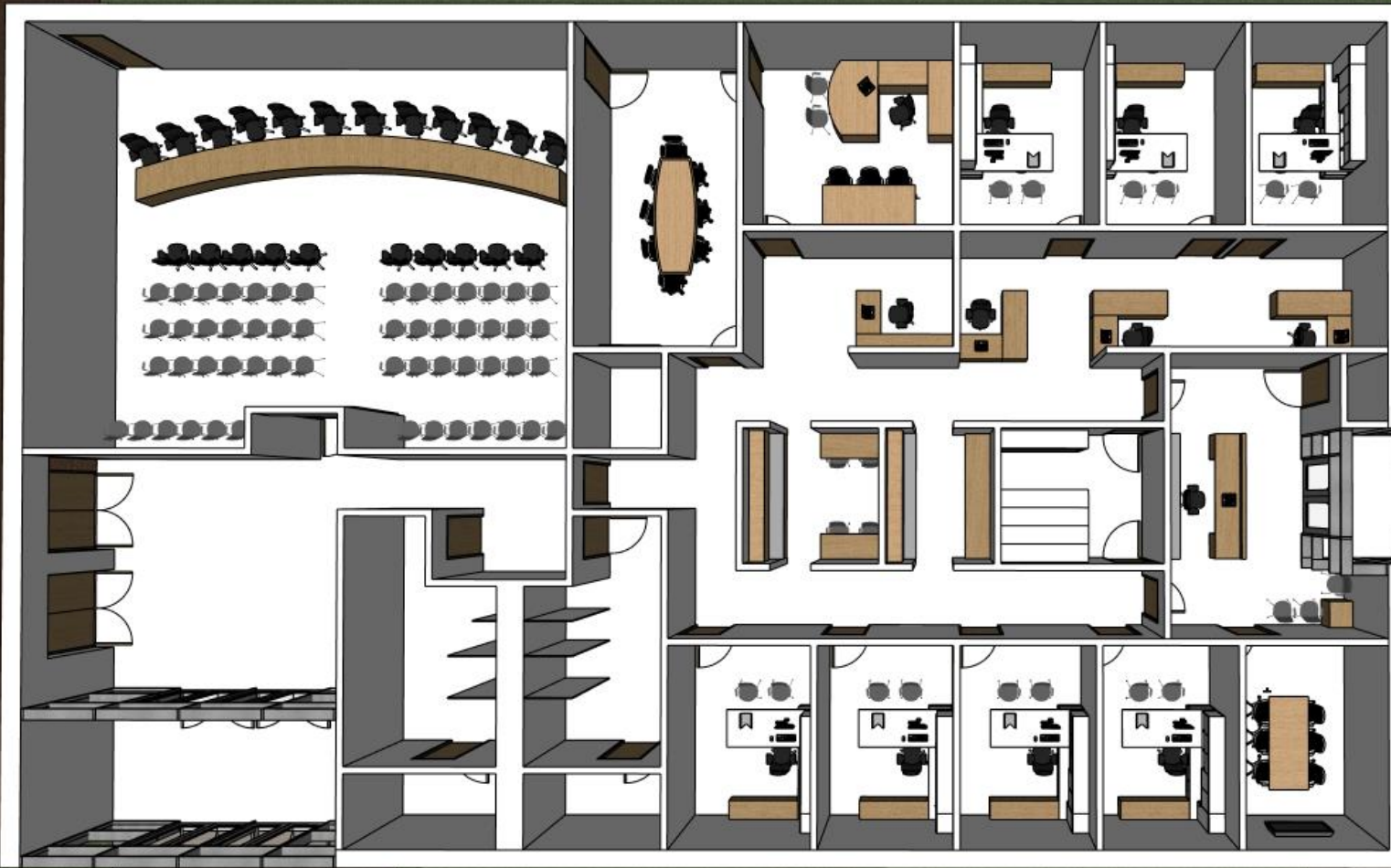

PALMERTON AREA ACTION PLAN

LISTEN



January - February 2025

- January 7th Board Workshop Meeting
- January 14th Town Hall Meeting
- January 21st Regular Board Meeting
- Meet with teachers and administration
- February 18th Board Update

LEAD

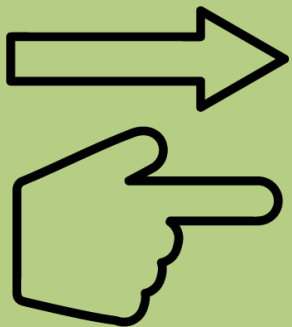

March – December 2025

- Document selected construction option for construction
- Submit for Township and County building approvals
- Present to the community and school board multiple times

Discussion

