



Palmyerton Area High School

January 7, 2025



Tonight's Discussion:

- Relocate high school administration and main visitor's entrance
- Enhance security
 - School visitors
 - Gym/Auditorium visitors
- Provide additional classrooms
 - Create room for 6th Grade
- Consider district office addition at high school



Challenges:

- Existing high school administration is away from front entry
- Location of front entry not clear from exterior
- Visitor parking should be located near front
- Maintain event entrance at gym/auditorium lobby with security options



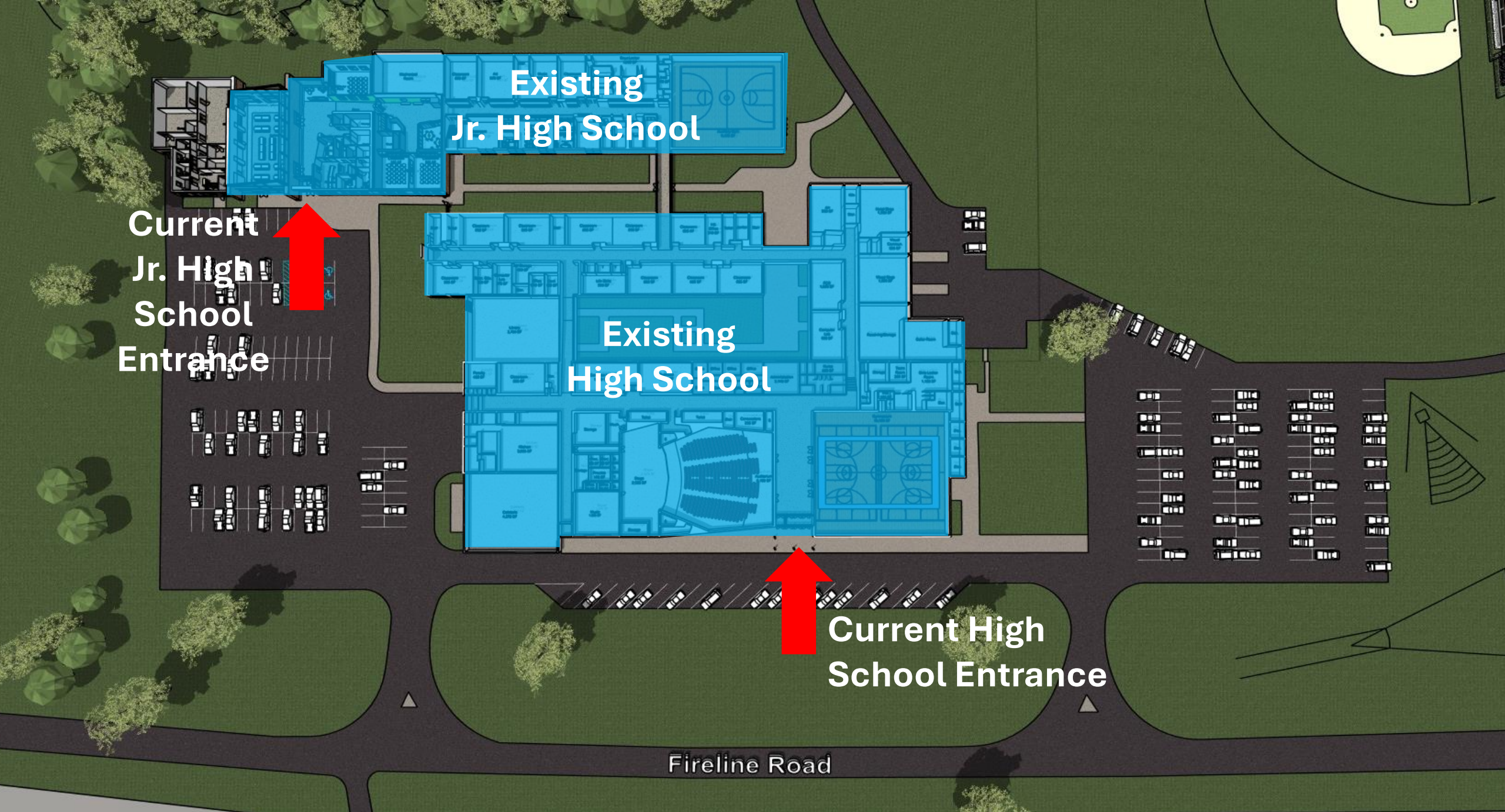

Existing
Jr. High School

Current
Jr. High
School
Entrance

Existing
High School

Current High
School Entrance

Fireline Road

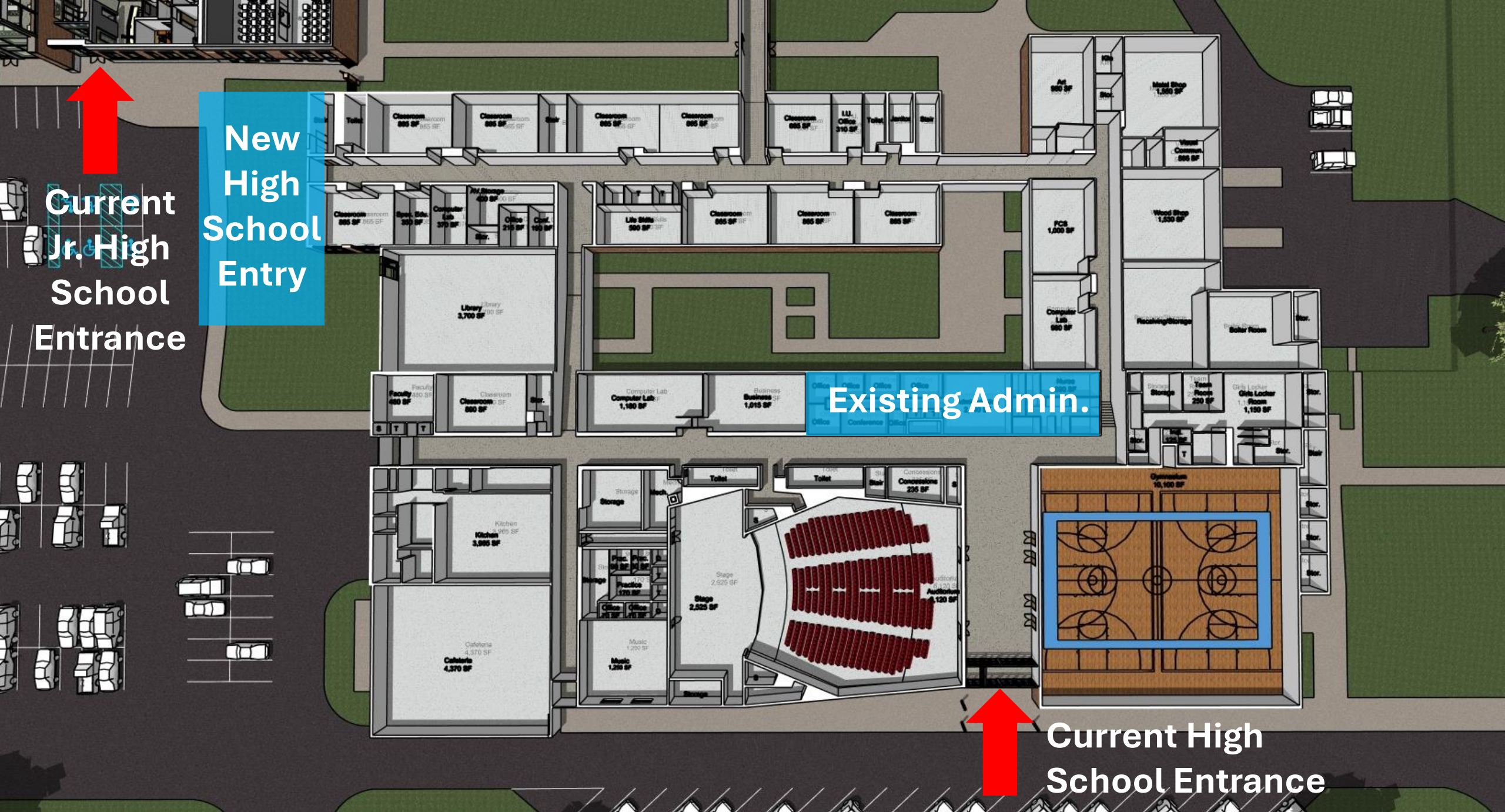

Current Jr. & High School Entrance

New High School Entry

Existing Admin.



Current High School Entrance





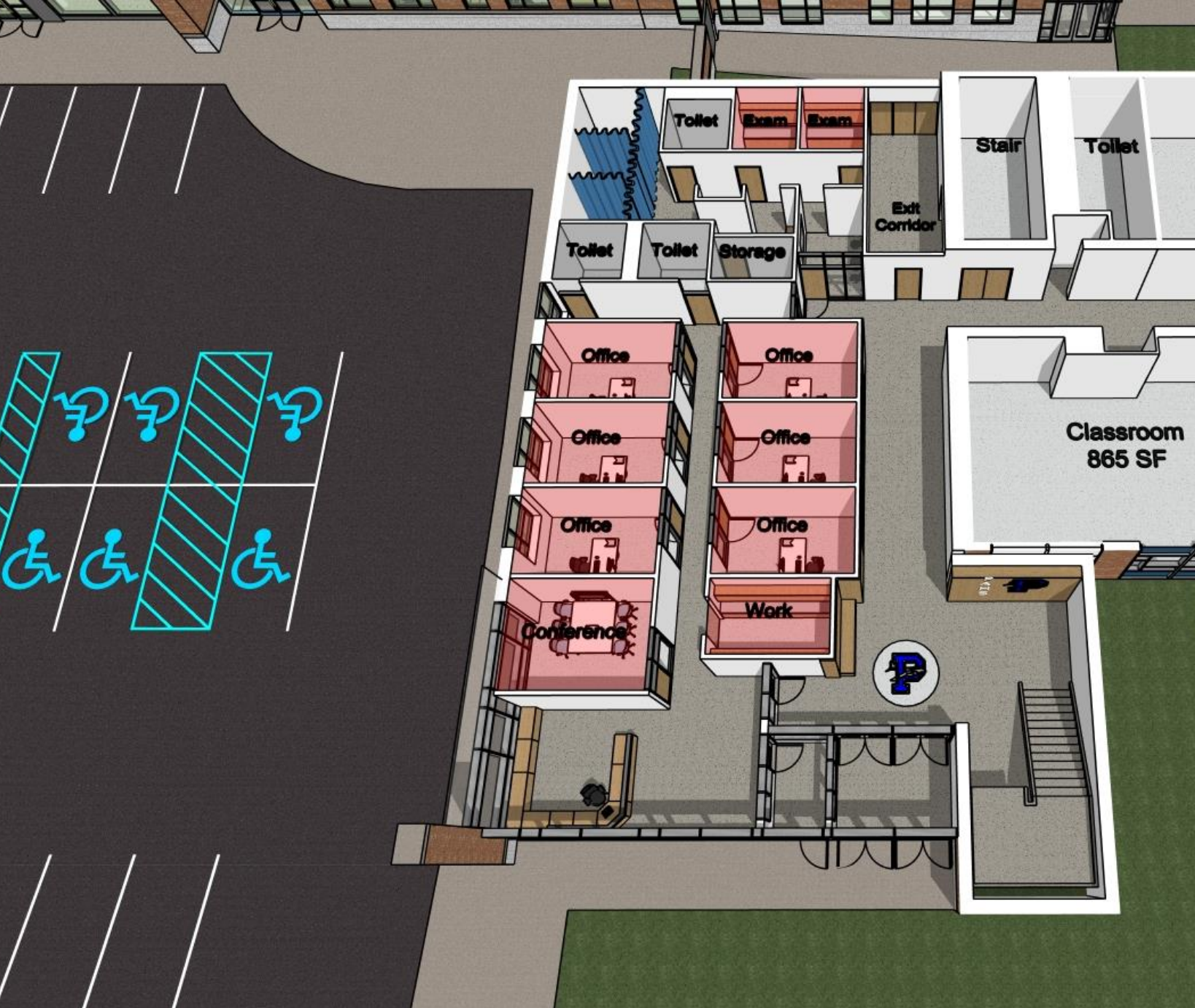

What's Included:

- **New secure main entry vestibule**
- **Admin/reception area**
- **(6) admin. offices**
- **(1) conference room**
- **Nurse's suite**
 - Toilet rooms
 - Exam rooms
 - Cot area
 - Storage

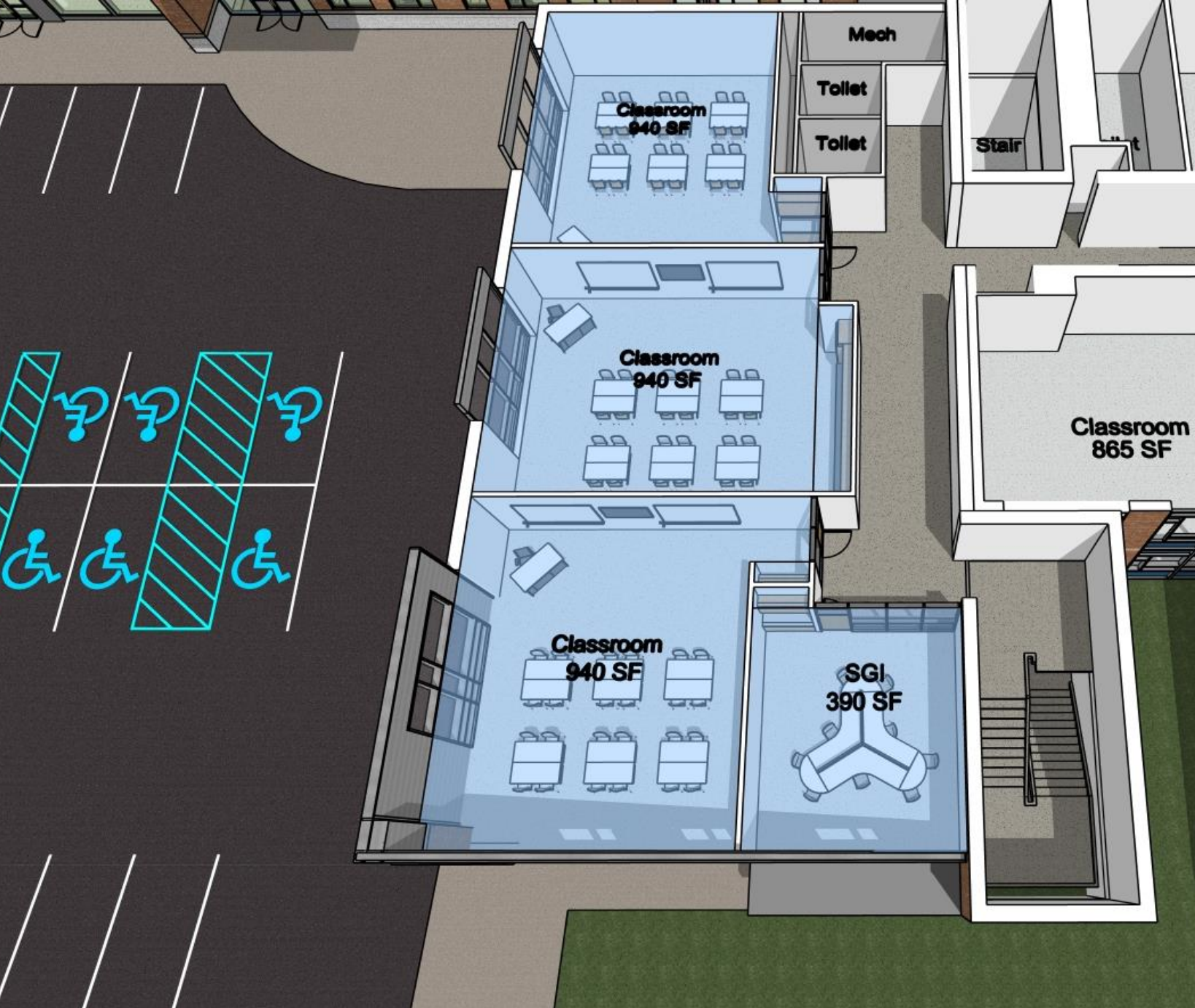

What's Included:

- **(3) new classrooms**
- **(1) Small Group Instruction room**
 - Learning support for 8-10 students
- **(2) toilet rooms**
- **New fire stair**









What's Existing:

- (6) admin. offices
- (1) conference room
- Nurse's suite

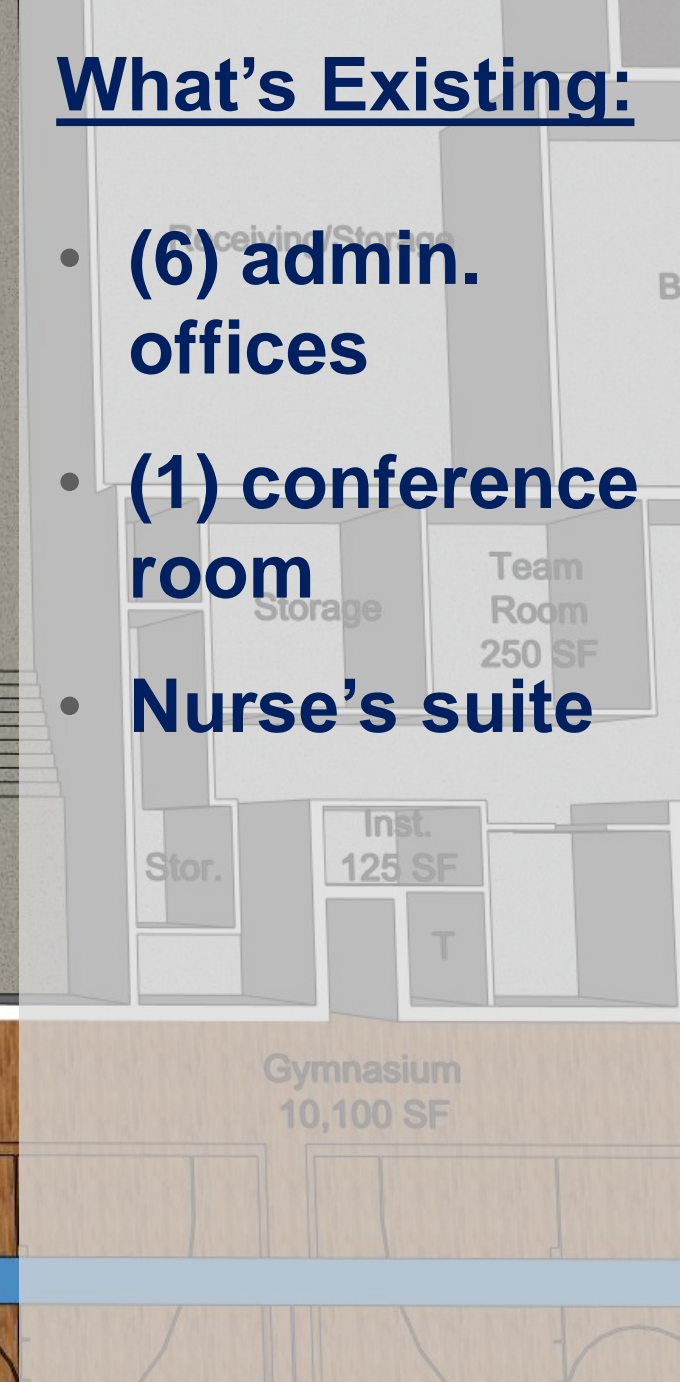

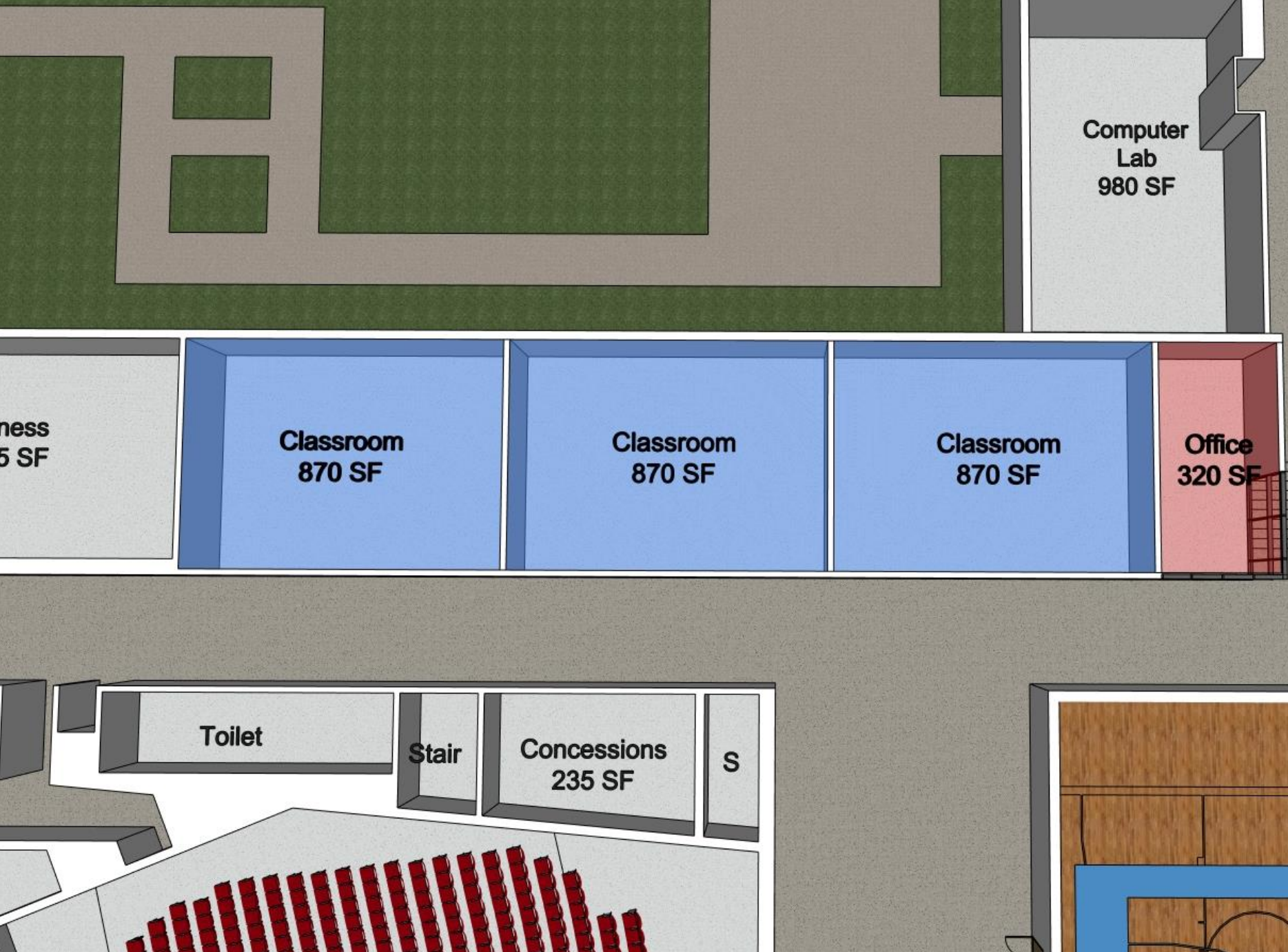

What's Included:

- (3) new classrooms
- (1) assistant principal's office

*** Total gain = 6 new classrooms**

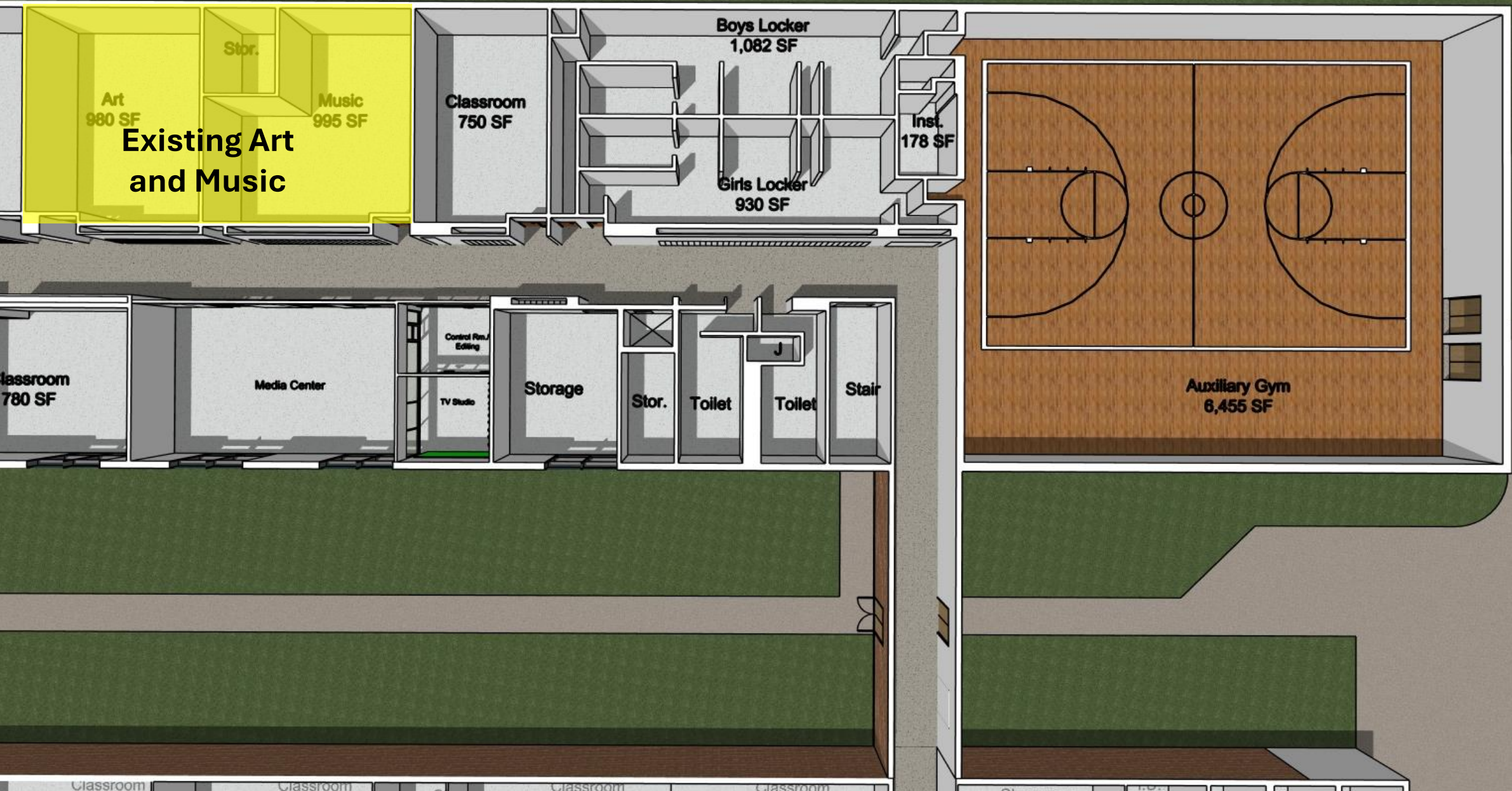

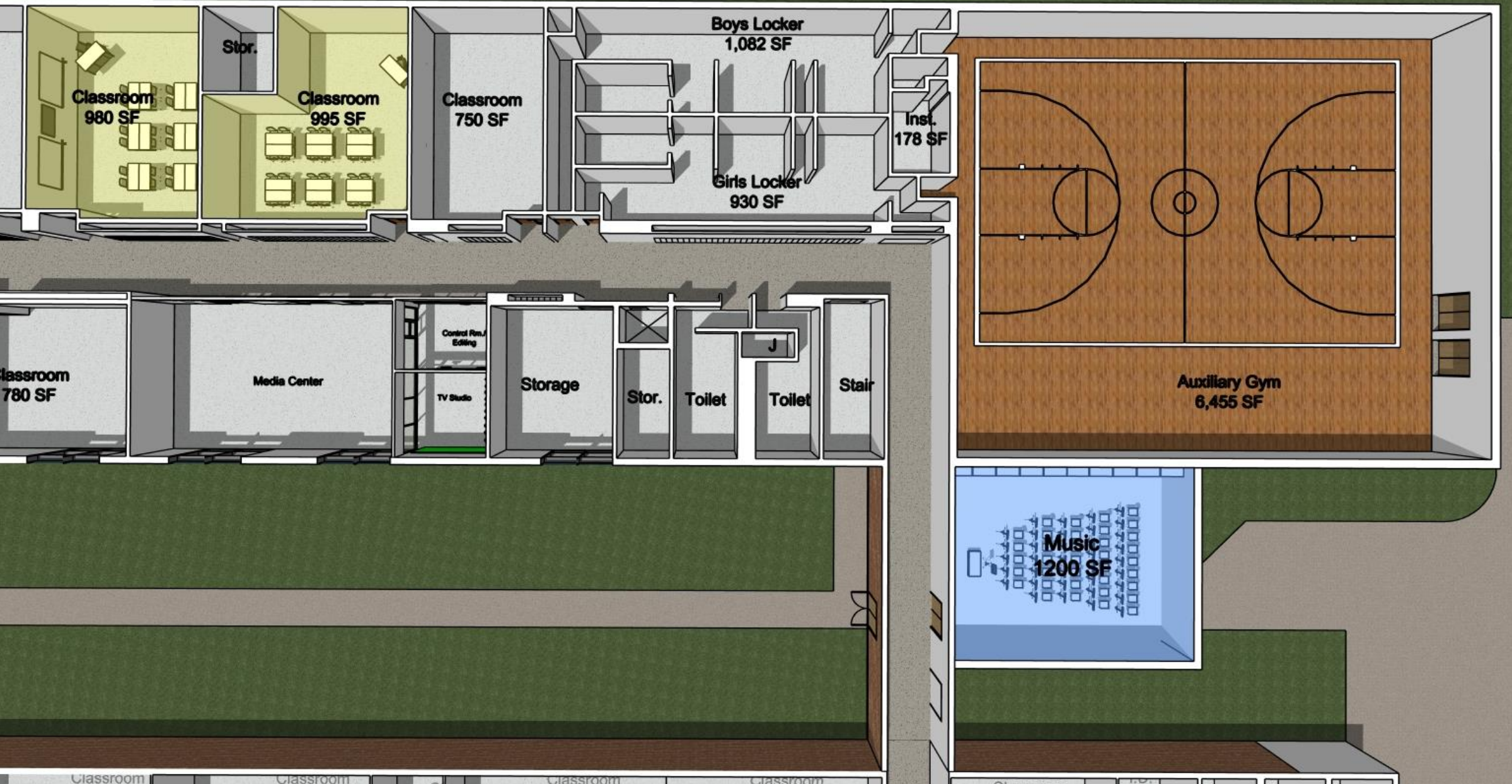

What's Included:

- (2) new large classrooms
- Spaces could be devoted to Art and Music to accommodate additional middle school students

* Total gain = 8 new classrooms

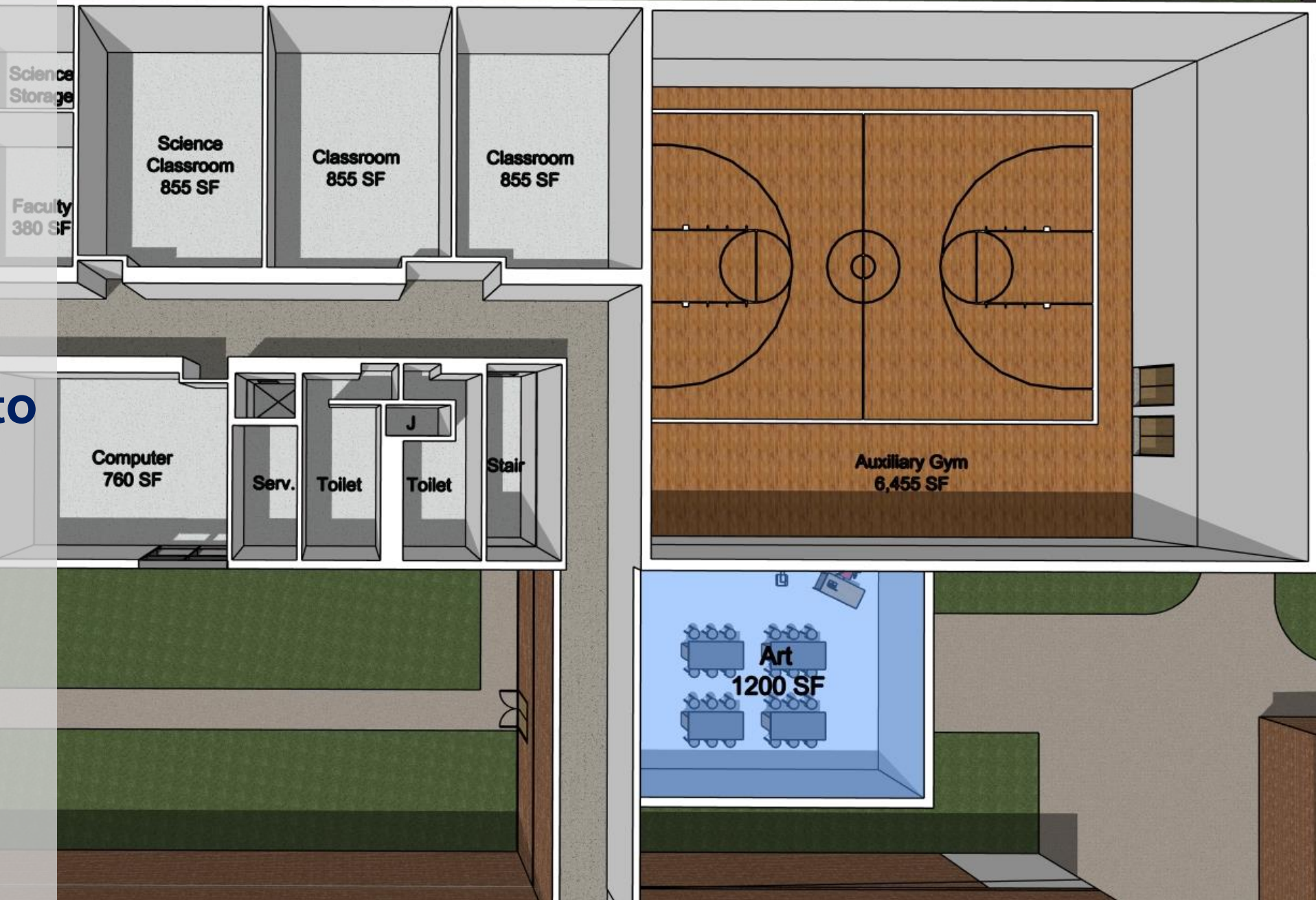



Existing
Jr. High School

Proposed
District Offices

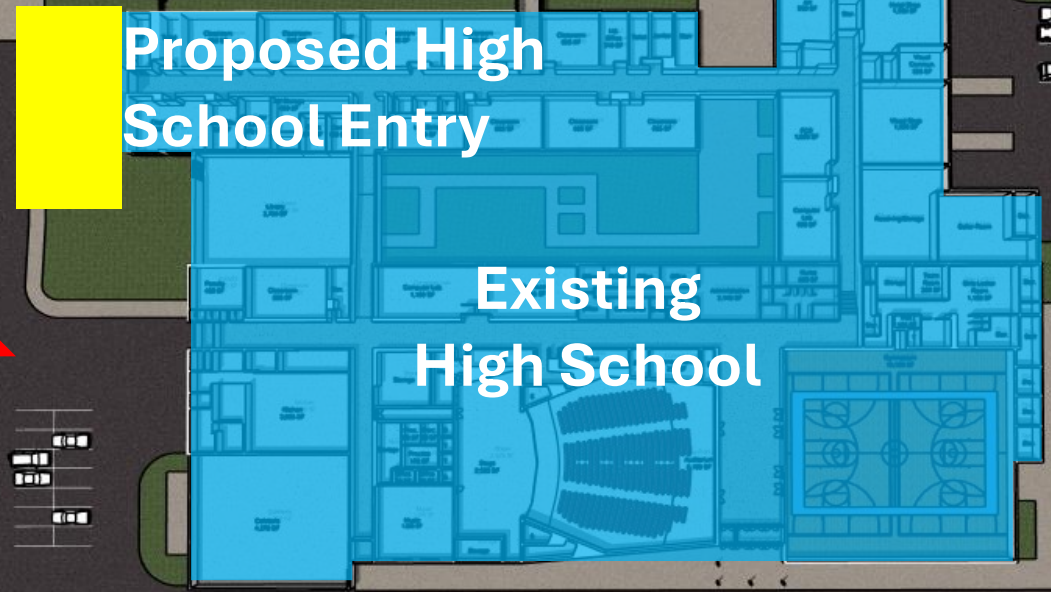

Proposed High
School Entry

Existing
High School



School
Traffic



Office
Traffic

Fireline Road



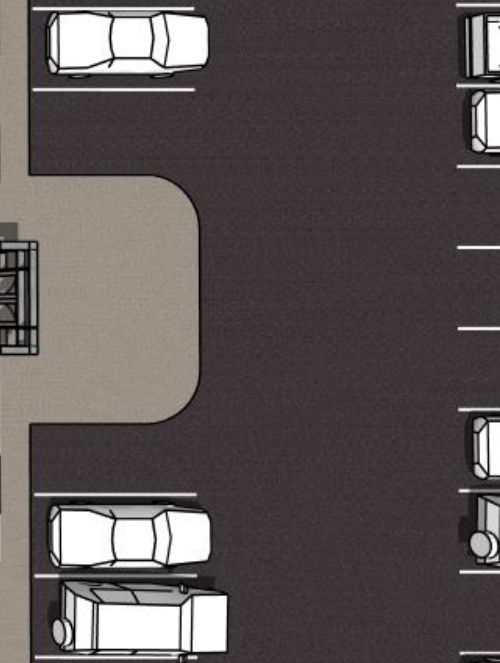
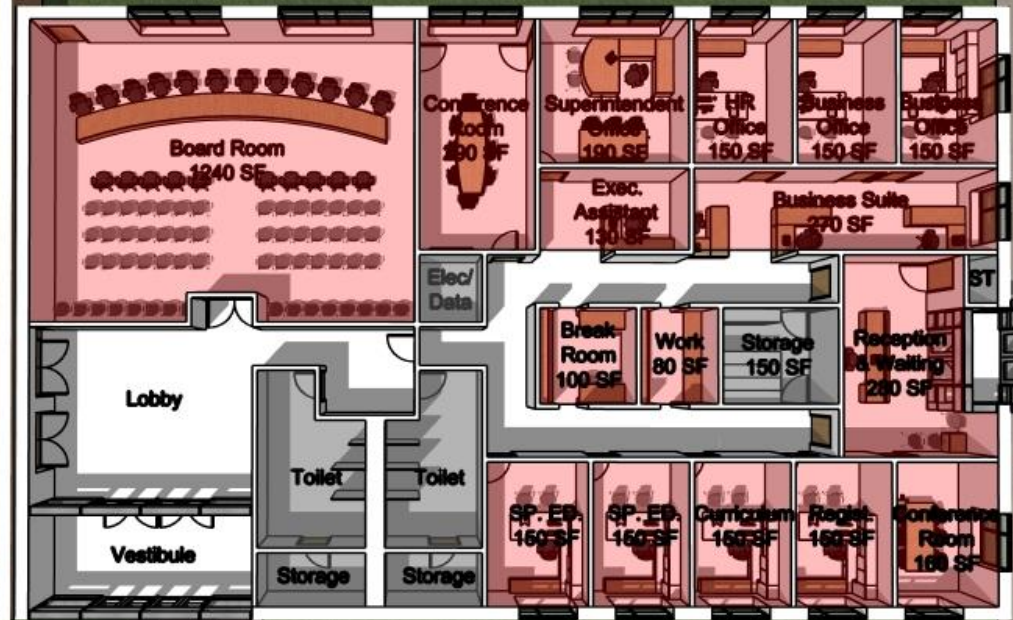
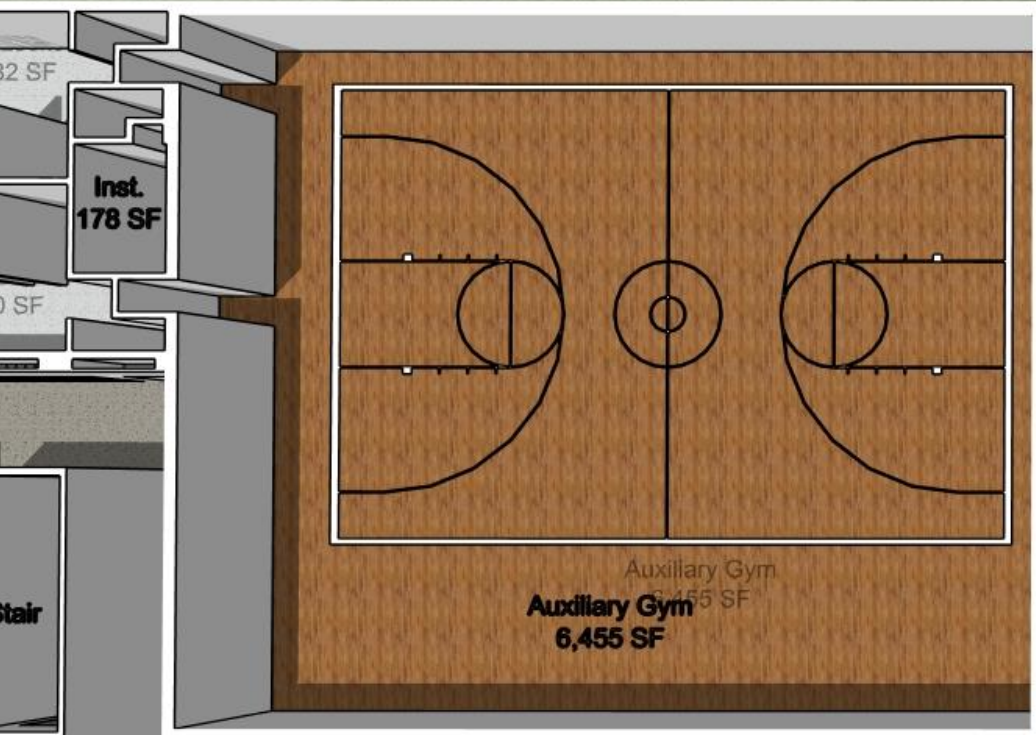

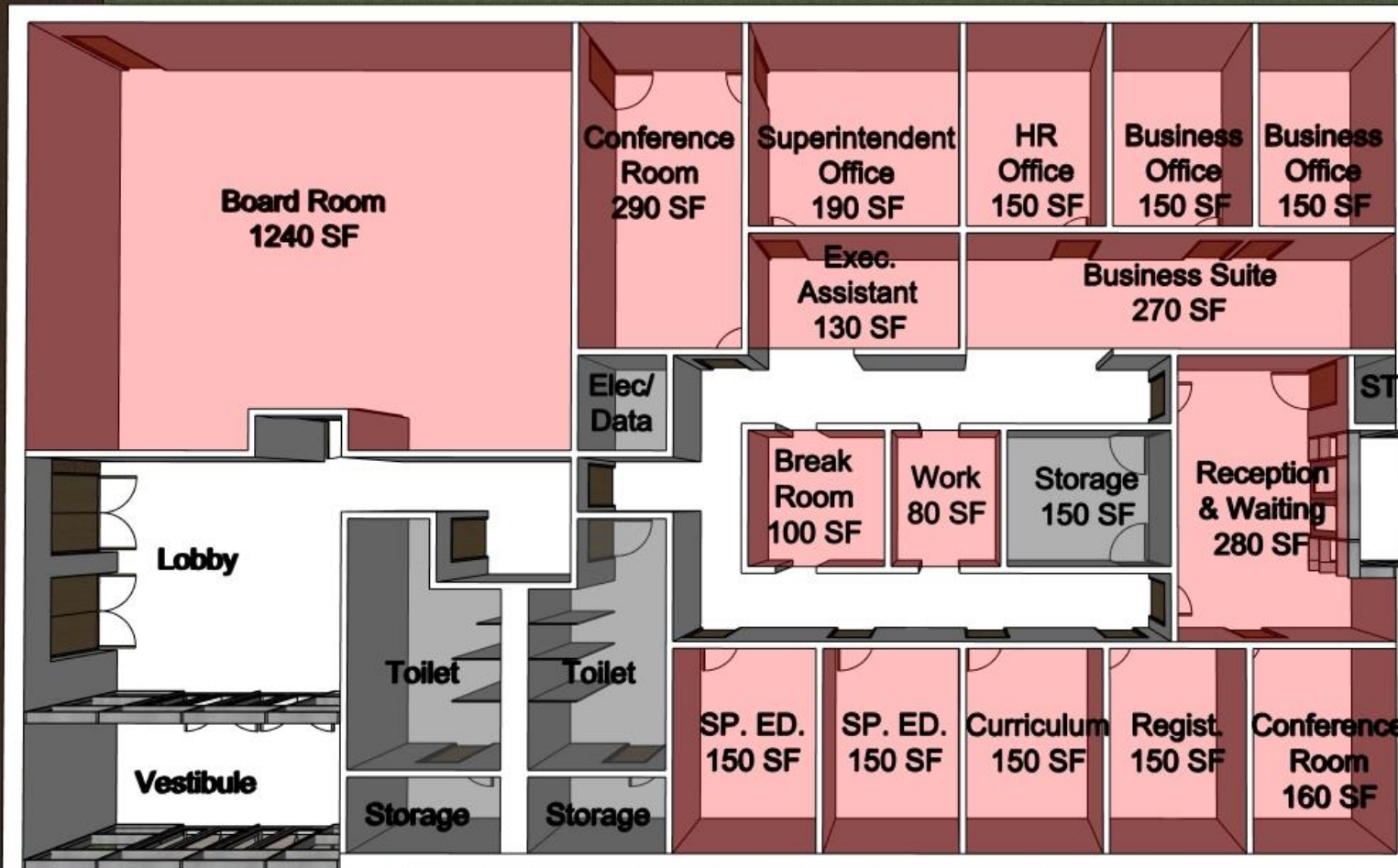

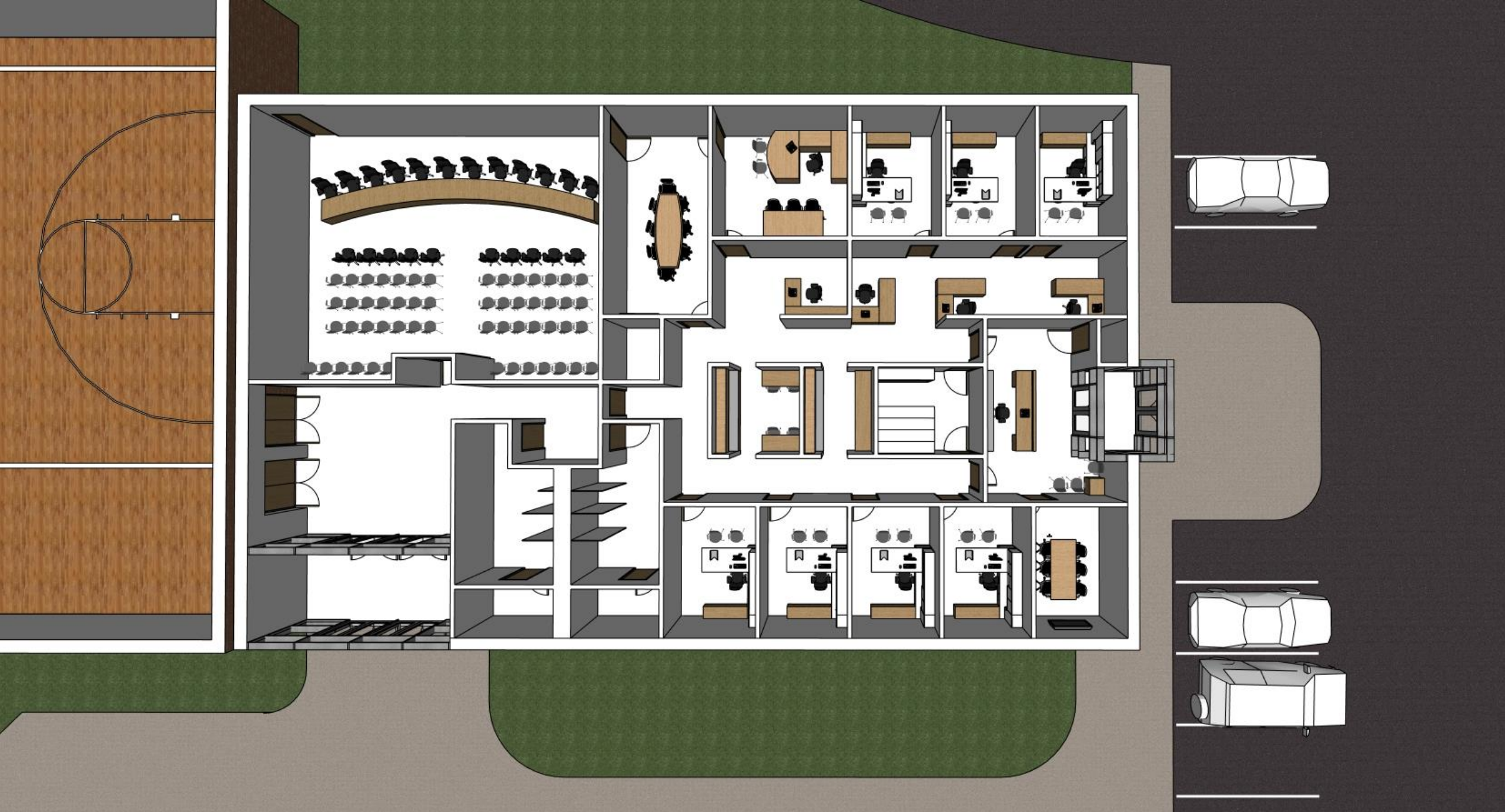



Project Budget:

New high school entrance and classrooms:

Addition and renovation cost = \$6.5m

Construction Contingency 8% = \$500k

Soft Costs (permits & fees) 15% = \$1m

Furniture and Equipment Allowance = \$300k

TOTAL PROJECT COST = \$8.3m

Cost for two additional classrooms = \$1.8m

Cost for district office addition = \$4.7m

PALMERTON AREA ACTION PLAN

LISTEN



January - February 2025

- January 7th Board Workshop Meeting
- January 14th Town Hall Meeting
- January 21st Regular Board Meeting
- Meet with teachers and administration
- February 18th Board Update

LEAD

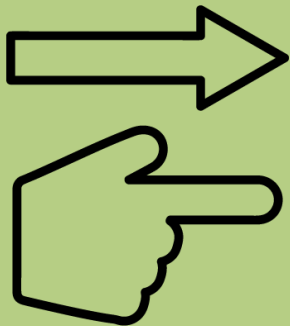

March – December 2025

- Document selected construction option for construction
- Submit for Township and County building approvals
- Present to the community and school board multiple times







interact
believe
learn
imagine



reflect
solve
create
grow
think

Dream discover IMAGINE innovate LEAD live Inspire Explore Play





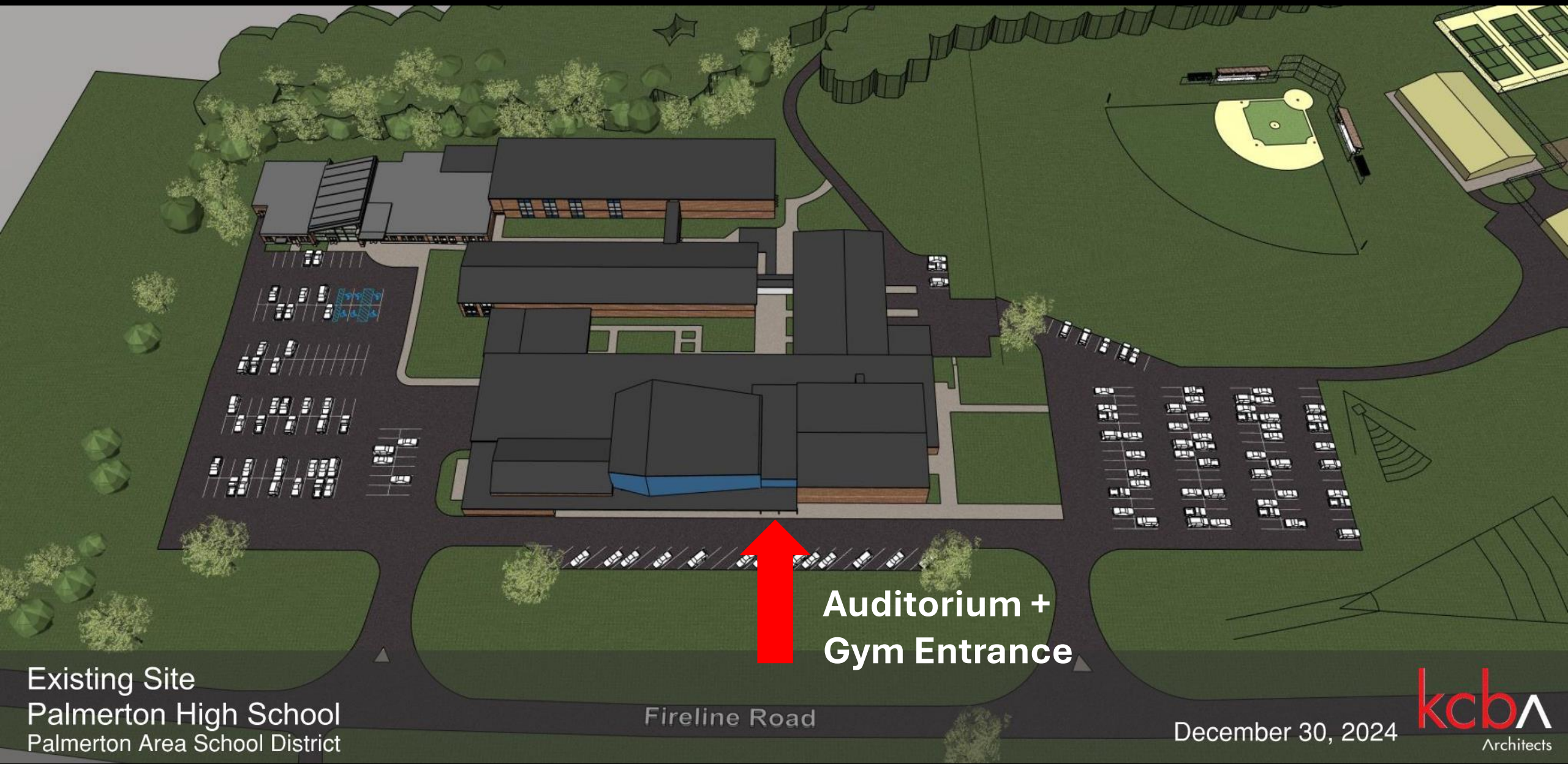

Existing Site
Palmerton High School
Palmerton Area School District

Fireline Road

Auditorium +
Gym Entrance

December 30, 2024

kcbA
Architects



Existing Lobby
Palmerton High School
Palmerton Area School District

December 30, 2024





Proposed Lobby
Palmerton High School
Palmerton Area School District

December 30, 2024

